

Identification of enclosures

Connector inserts and their enclosures are numerous and therefore the search for the correct pairing of one with another can be complex.

To facilitate this operation (in addition to the normal part number) the definition of “**size**” has been introduced in this catalogue.

As indicated in the illustration on the left and in the table below the size value refers to the screw fixing centre distances which constitute a unique element since they are common to both the inserts and the enclosures.

All the pages that illustrate combinable articles (inserts and enclosures) carry references as per the examples illustrated on the opposite page.

Following is a table that shows all the sizes of the enclosures and the dimensions of the housings where the inserts will be fastened.

enclosures size	insert housing with screw fixing centre distance x-y
“21.21”	(21 x 21 mm) **
“32.13”	32 x 13 mm
“49.16”	49.5 x 16 mm
“66.16”	66 x 16 mm
“66.40”	66 x 16 mm (2 inserts)
“44.27”	44 x 27 mm
“57.27”	57 x 27 mm
“77.27”	77.5 x 27 mm
“104.27”	104 x 27 mm
“77.62”	77.5 x 27 mm (2 inserts)
“104.62”	104 x 27 mm (2 inserts)

** dimensions relating to the insert cross-section size not being able to identify a screw fixing centre distance since provided with a single screw.

inserts:		page
CK	3 poles + ⊕	40
CK	4 poles + ⊕	40
CKS	3 poles + ⊕	41
CKS	4 poles + ⊕	41
CD	7 poles + ⊕	45
CD	8 poles	46
CQ	5 poles + ⊕	69
CQ	12 poles + ⊕	68

insert dimensions:
21 x 21 mm

bulkhead mounting housings



angled bulkhead mounting housings



description	part no.	part no. (entry - Pg 11)	part no. (entry - M 20)
with lever	CK 03 I (white)		
with lever	CK 03 IN (black)		
without cable gland entry, with lever		CK 03 IA (white)	
without cable gland entry, with lever		CK 03 IAN (black)	
with cable gland entry and lever		CK 03 IAPS (white)	MK IAP20 (white)
with cable gland entry and lever		CK 03 IAPNS (black)	MK IAPN20 (black)
gasket and screw kit for IP66/IP67 ¹⁾ for CK, CQ 05, CKS inserts	CKR 65	CKR 65	
gasket and screw kit for IP66/IP67 ¹⁾ for CD 07/08 inserts	CKR 65 D	CKR 65 D	

panel cut-out for enclosures, in mm

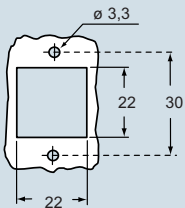

1) To obtain the protection rating IP66/IP67 a kit is provided that includes a gasket to fit under the insert fixing screws supplied with the kit (see illustrative example)
CQ 12 inserts are already supplied with a gasket and screw which ensure IP66/IP67 protection rating

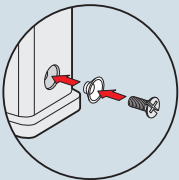

dimensions in mm

CK I(N)

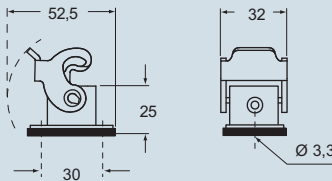

dimensions in mm

CK IA(N)

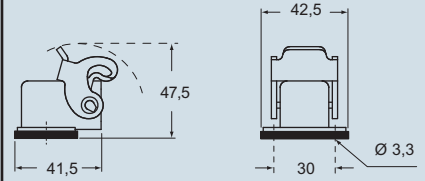

CK IAP(N)S and MK IAP(N)

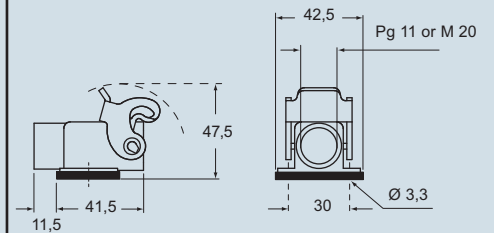

CAVUS

Type 12
Type 4/4X only
with CKR 65 (D)



IP66/IP67 with CKR 65 (D) ¹⁾

dimensions shown are not binding
and may be changed without notice

inserts:		page
CK	3 poles + ⊕	40
CK	4 poles + ⊕	40
CKS	3 poles + ⊕	41
CKS	4 poles + ⊕	41
CD	7 poles + ⊕	45
CD	8 poles	46
CQ	5 poles + ⊕	69
CQ	12 poles + ⊕	68

insert dimensions:
21 x 21 mm

hoods



covers



description	part no. (entry - Pg 11)	part no. (entry - M 20)	part no.
with pegs, top entry	CK 03 VS (white)	MK V20 (white)	
with pegs, top entry	CK 03 VNS (black)	MK VN20 (black)	
with pegs, top entry	CK 03 VAS (white)	MK VA20 (white)	
with pegs, top entry	CK 03 VANS (black)	MK VAN20 (black)	
with lever, top entry	CK 03 VGS (white)	MK VG20 (white)	
with lever, top entry	CK 03 VGNS (black)	MK VGN20 (black)	
with pegs and gasket, for female inserts			CK 03 C (white)
with pegs and gasket, for female inserts			CK 03 CN (black)
with pegs, for male inserts			CK 03 CA (white)
with pegs, for male inserts			CK 03 CAN (black)
with lever and gasket, for female inserts			CK 03 CX (white)
with lever and gasket, for female inserts			CK 03 CXN (black)
with lever, for male inserts			CK 03 CXA (white)
with lever, for male inserts			CK 03 CXAN (black)
gasket and screw kit for IP66/IP67 ¹⁾ for CK, CQ 05, CKS inserts	CKR 65		
gasket and screw kit for IP66/IP67 ¹⁾ for CD 07/08 inserts	CKR 65 D		

1) To obtain the protection rating IP66/IP67 a kit is provided that includes a gasket to fit under the insert fixing screws supplied with the kit (see illustrative example)
CQ 12 inserts are already supplied with a gasket and screw which ensure IP66/IP67 protection rating

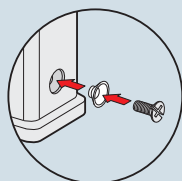

dimensions in mm

CK V(N)S and MK V(N)

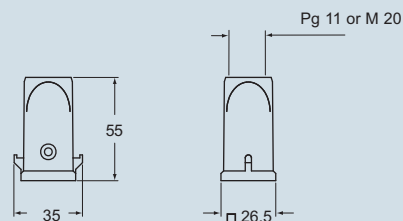

CK VA(N)S and MK VA(N)

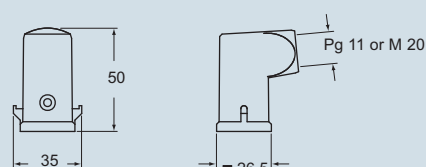

CK VG(N)S and MK VG(N)

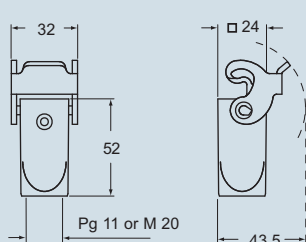

dimensions in mm

CK C(N)

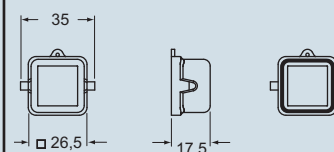

CK CA(N)

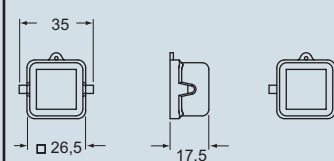

CK CX(N)

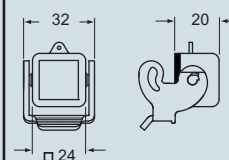

CK CXA(N)

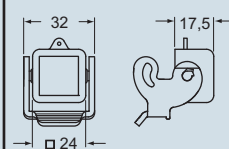

Type 12
Type 4/4X only
with CKR 65 (D)



IP66/IP67 with CKR 65 (D) ¹⁾

dimensions shown are not binding
and may be changed without notice

inserts:		page
CK	3 poles + ⊕	40
CK	4 poles + ⊕	40
CKS	3 poles + ⊕	41
CKS	4 poles + ⊕	41
CD	8 poles	46
CQ	5 poles + ⊕	69
CQ	12 poles + ⊕	68

insert dimensions:
21 x 21 mm

bulkhead mounting housings



angled bulkhead mounting housings



description	part no.	part no. (entry - Pg 11)	part no. (entry - M 20)
with galvanised steel lever with stainless steel lever	CKA 03 I CKAX 03 I		
without cable gland, galvanized steel lever without cable gland, stainless steel lever		CKA 03 IA CKAX 03 IA	
with cable gland, galvanized steel lever with cable gland, stainless steel lever with cable gland, galvanized steel lever, bulkhead hole closed with cable gland, stainless steel lever, bulkhead hole closed		CKA 03 IAPS CKAX 03 IAPS CKA 03 APS CKAX 03 APS	MKA IAP20 MKAX IAP20 MKA AP20 MKAX AP20
gasket and screw kit for IP66/IP67 ¹⁾ for CK, CQ 05, CKS inserts	CKR 65	CKR 65	
gasket and screw kit for IP66/IP67 ¹⁾ for CD 07/08 inserts	CKR 65 D	CKR 65 D	

panel cut-out for enclosures, in mm

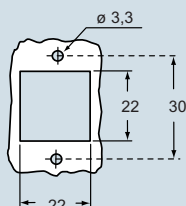

1) To obtain the protection rating IP66/IP67 a kit is provided that includes a gasket to fit under the insert fixing screws supplied with the kit (see illustrative example)
CQ 12 inserts are already supplied with a gasket and screw which ensure IP66/IP67 protection rating

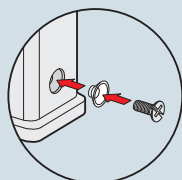

Type 12
Type 4/4X only
with CKR 65 (D)



IP66/IP67 with CKR 65 (D) ¹⁾

dimensions shown are not binding
and may be changed without notice

dimensions in mm

CKA I

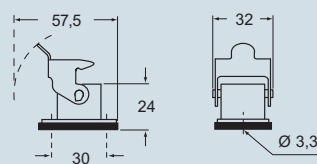

CKAX I

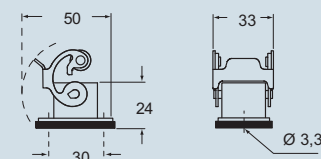

dimensions in mm

CKA IA

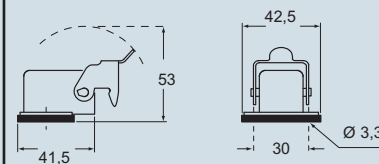

CKAX IA

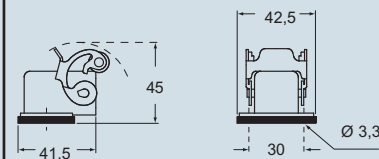

CKA IAPS (CKA APS) and MKA IAP (MKA AP)

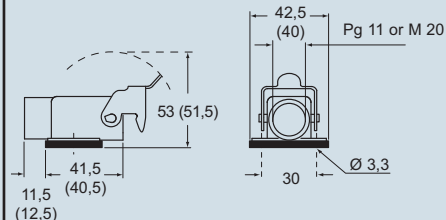

CKAX IAPS (CKAX APS) and MKAX IAP (MKAX AP)

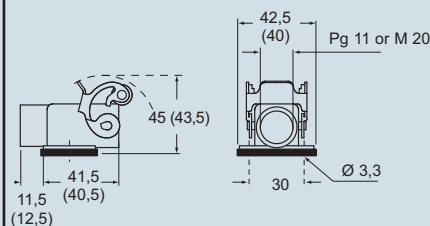

inserts:		page
CK	3 poles + ⊕	40
CK	4 poles + ⊕	40
CKS	3 poles + ⊕	41
CKS	4 poles + ⊕	41
CD	8 poles	46
CQ	5 poles + ⊕	69
CQ	12 poles + ⊕	68

insert dimensions:
21 x 21 mm

angled bulkhead mounting housings

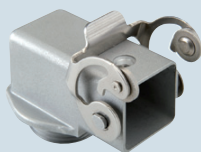

NEW

description	part no.
galvanized steel lever, M20 fixing thread (*)	MKA IAF20 ¹⁾
stainless steel lever, M20 fixing thread (*)	MKAX IAF20 ¹⁾
galvanized steel lever, M25 fixing thread (*)	MKA IAF25 ¹⁾
stainless steel lever, M25 fixing thread (*)	MKAX IAF25 ¹⁾
gasket and screw kit for IP66/IP67 ¹⁾ for CK, CQ 05, CKS inserts	CKR 65
gasket and screw kit for IP66/IP67 ¹⁾ for CD 07/08 inserts	CKR 65 D

panel cut-out

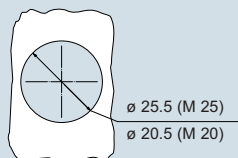

(*) locknut supplied on request, see catalogue cable glands (articles AS M20N and AS M25N metallic, AS M20L and AS M25L insulating)

1) To obtain the protection rating IP66/IP67 a kit is provided that includes a gasket to fit under the insert fixing screws supplied with the kit (see illustrative example)
CQ 12 inserts are already supplied with a gasket and screw which ensure IP66/IP67 protection rating

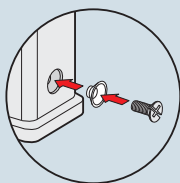

dimensions in mm

MKA IAF

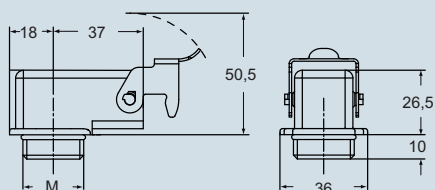

MKAX IAF

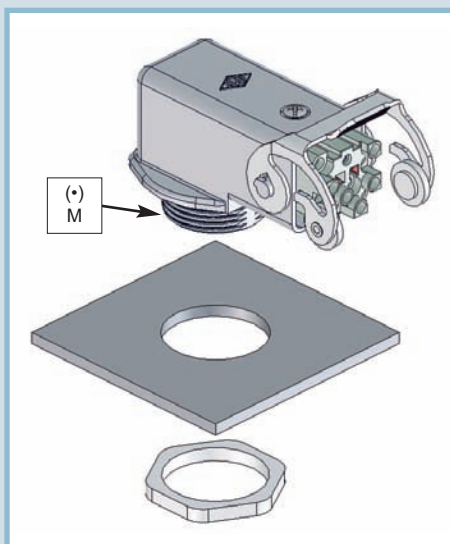
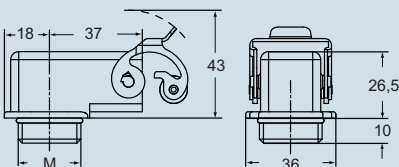

IP66/IP67 with CKR 65 (D) ¹⁾

dimensions shown are not binding
and may be changed without notice

inserts:		page
CK	3 poles + ⊕	40
CK	4 poles + ⊕	40
CKS	3 poles + ⊕	41
CKS	4 poles + ⊕	41
CD	8 poles	46
CQ	5 poles + ⊕	69
CQ	12 poles + ⊕	68

insert dimensions:
21 x 21 mm

hoods



covers

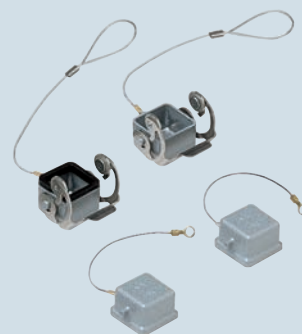

description	part no. (entry - Pg 11)	part no. (entry - M 20)	part no.
with pegs, side entry with pegs, side entry	CKA 03 VS CKA 03 VAS	MKA V20 MKA VA20	
with galvanised steel lever, top entry with stainless steel lever, top entry	CKA 03 VGS CKAX 03 VGS	MKA VG20 MKAX VG20	
with pegs and gasket, for female inserts with pegs, for male inserts			CKA 03 C 1) CKA 03 CA 1)
with stainless steel lever and gasket, for female inserts with stainless steel lever, for male inserts			CKAX 03 CX CKAX 03 CXA
gasket and screw kit for IP66/IP67 ²⁾ for CK, CQ 05, CKS inserts	CKR 65		
gasket and screw kit for IP66/IP67 ²⁾ for CD 08 inserts	CKR 65 D		

- 1) preferably be used with enclosures CKAX (stainless steel lever).
2) To obtain the protection rating IP66/IP67 a kit is provided that includes a gasket to fit under the insert fixing screws supplied with the kit (see illustrative example)
CQ 12 inserts are already supplied with a gasket and screw which ensure IP66/IP67 protection rating

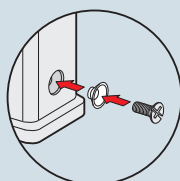

dimensions in mm

CKA VS and MKA V

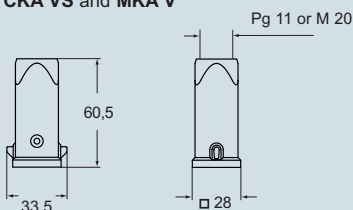

CKA VAS and MKA VA

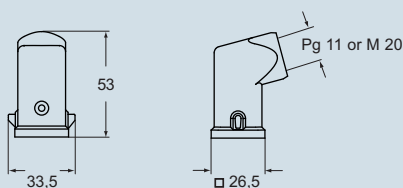

CKA VGS and MKA VG

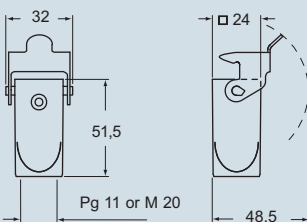

CKAX VGS and MKAX VG

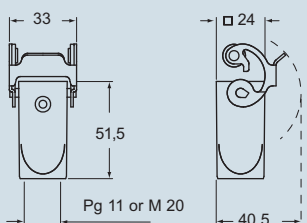

dimensions in mm

CKA C

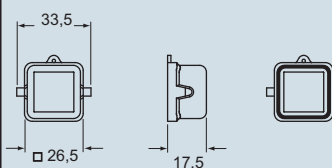

CKA CA

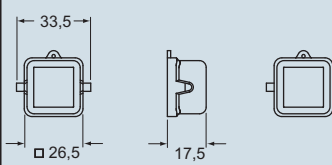

CKAX CX

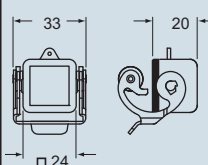

CKAX CXA

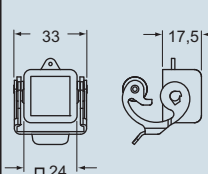

Type 12
Type 4/4X only
with CKR 65 (D)



IP66/IP67 with CKR 65 (D) ²⁾

dimensions shown are not binding
and may be changed without notice

inserts: page
CQ 08 8 poles + ⊕ 70
CQ 04/2 4 poles + 2 poles + ⊕ 71

**bulkhead mounting housing
with single lever**

hoods with 2 peg



description	part no.	entry Pg	part no.	entry Pg
with lever without cable gland entry, angled, with lever with cable gland entry, angled, with lever	CQ 08 I CQ 08 IA CQ 08 IAP	21		
with pegs, side entry *			CQ 08 VA	16
with pegs, top entry *			CQ 08 V	21

* Pg male thread on enclosure exterior

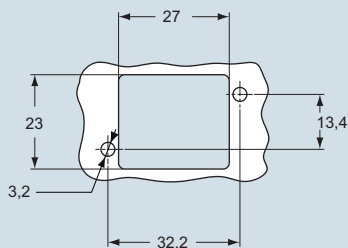
panel cut-out for CQ I enclosure, in mm

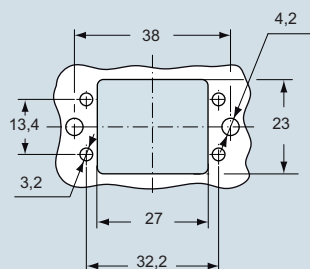

panel cut-out for CQ IA - CQ IA enclosure, in mm



dimensions in mm

CQ I

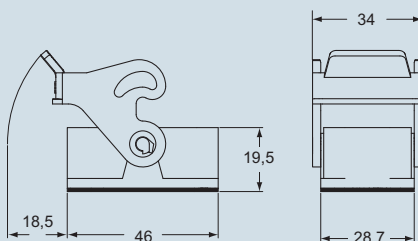

CQ IA

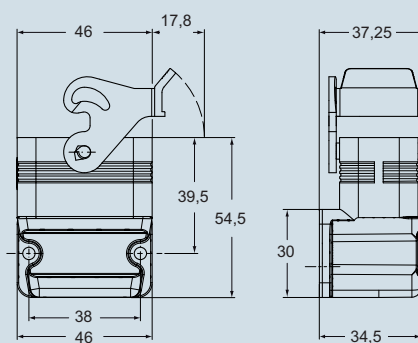

CQ IAP

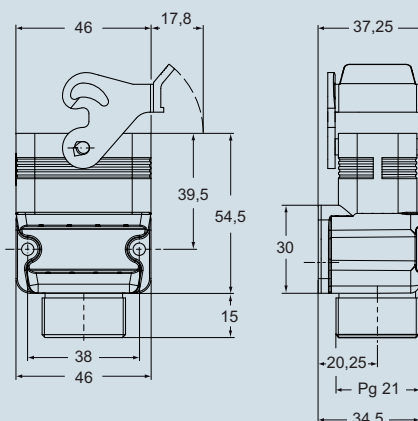

dimensions in mm

CQ VA

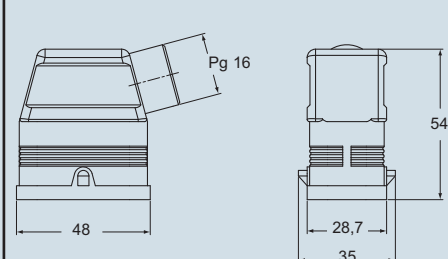

CQ V

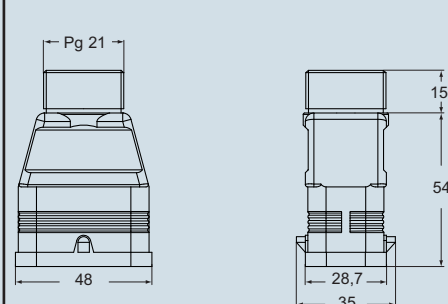

dimensions shown are not binding
and may be changed without notice



inserts:	page
CQ 08 8 poles + ⊕	70
CQ 04/2 4 poles + 2 poles + ⊕	71

hoods with 2 peg



covers with 2 peg
thermoplastic resin cable glands



description	part no.	entry Pg	part no.
with lever, top entry *	CQ 08 VG	21	
cover with 2 pegs for female inserts cover with 2 pegs for male inserts			CQ 08 C CQ 08 CA
cable gland head and gasket for CQ 08 VA enclosure cable gland head and gasket for CQ 08 V and VG enclosure			CRQ 16 CRQ 21

** Pg male thread on enclosure exterior

cable diameters for cable glands:
- CRQ 16: 10 - 14.5 mm
- CRQ 21: 14 - 18 mm

dimensions in mm

CQ VG

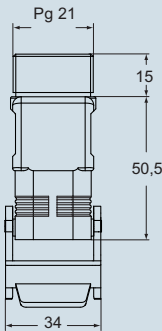
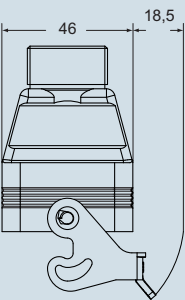

dimensions in mm

CQ C and CQ CA

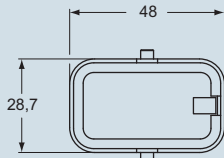

CRQ 16 e CRQ 21

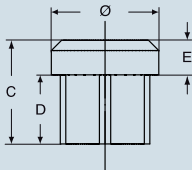
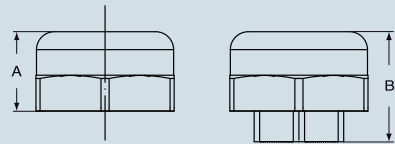
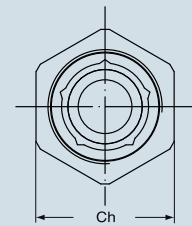

part	A	B	C	D	E	Ø	Ch
CRQ 16	15.5	21.5	20.25	13.5	6.75	21	27
CRQ 21	18.2	27.5	25	15.5	9	26.5	33



dimensions shown are not binding
and may be changed without notice



inserts:		page
CD	15 poles + ⊕	47
CDA	10 poles + ⊕	72
CDC	10 poles + ⊕	73
MIXO	1 module	156+195

bulkhead mounting housings
with single lever



surface mounting housings
with single lever



description	part no.	part no.	entry Pg	part no.	entry M
with simple lever	CZI 15 L				
with lever and cover	CZI 15 LS				
with simple lever		CZP 15 L	16		
with simple lever		CZP 15 L2	16 x 2	MZP 15 LS225	25
with simple lever		CZP 15 L21	21	MZP 15 L25	25
with lever and cover		CZP 15 LS221	21 x 2	MZP 15 LS225	25 x 2

panel cut-out for bulkhead mounting housings in mm

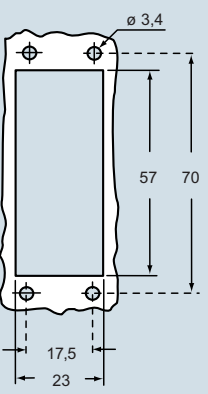

NB: the enclosures ensure IP66 protection (or IP65 for cover versions) rating when mated and locked with the closing levers.

dimensions in mm

CZI L

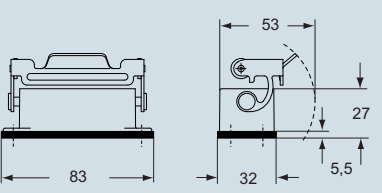

CZI LS

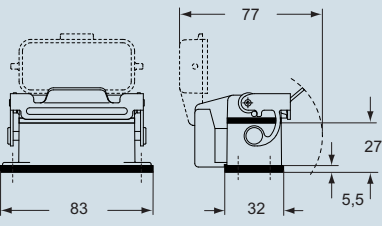

dimensions in mm

CZP L and MZP L

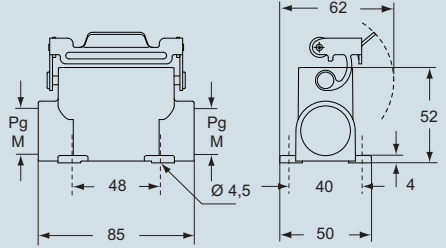

CZP LS and MZP LS

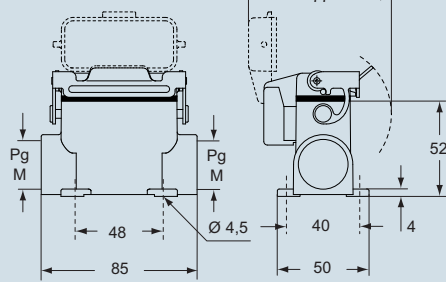

CALUS Type 4/4X/12



dimensions shown are not binding
and may be changed without notice

C-TYPE - size 49.16

inserts:		page
CD	15 poles + ⊕	47
CDA	10 poles + ⊕	72
CDC	10 poles + ⊕	73
MIXO	1 module	156+195

Cover versions L and LG cannot be used together with coding pins. If this application is required, please contact ILME SpA.

hoods with 2 pegs



covers

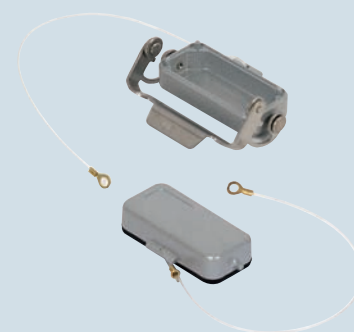

description	part no.	entry Pg	part no.	entry M	part no.
with pegs, top entry	CZO 15 L	16	MZO 15 L20	20	
with pegs, top entry			MZO 15 L25	25	
with pegs, top entry, high construction	CZAO 15 L16	16	MZAO 15 L20	20	
with pegs, top entry, high construction	CZAO 15 L21	21	MZAO 15 L25	25	
with pegs, side entry	CZV 15 L	13.5	MZV 15 L20	20	
with pegs, top entry, high construction	CZAV 15 L16	16	MZAV 15 L20	20	
with pegs, top entry, high construction	CZAV 15 L21	21	MZAV 15 L25	25	
with pegs, side entry, high construction, without adaptor *	CZFO 15 L16	16	MZFO 15 L20	20	
with pegs, side entry, high construction, without adaptor *	CZFO 15 L21	21	MZFO 15 L25	25	
with pegs, top entry, high construction, without adaptor *	CZFV 15 L16	16	MZFV 15 L20	20	
with pegs, top entry, high construction, without adaptor *	CZFV 15 L21	21	MZFV 15 L25	25	
with pegs (for 1 lever enclosures)					CZC 15 L
with simple lever (for enclosures with pegs)					CZC 15 LG

* enclosure without adaptor, threaded on the body, to enclosure to be used only with a complete cable gland.

dimensions in mm

CZO L and MZO L

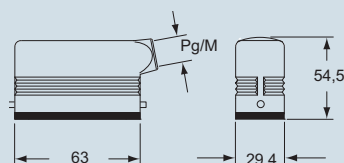

CZAO L - MZAO L and CZAV L - MZAV L

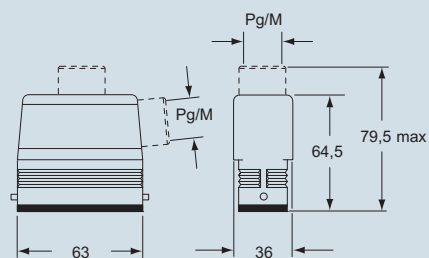

CZV L and MZV L

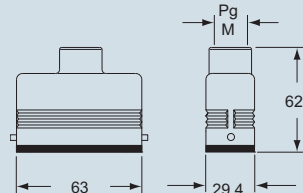

CZFO L - MZFO L and CZFV L - MZFV L

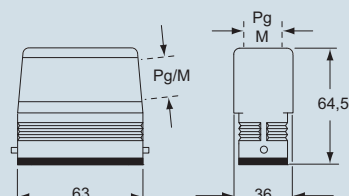

dimensions in mm

CZC L

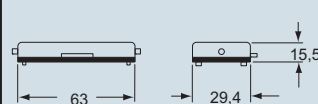

CZC LG

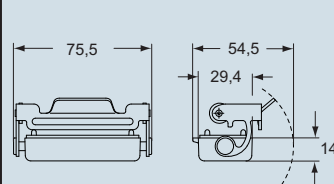

CALUS Type 4/4X/12



dimensions shown are not binding and may be changed without notice



inserts:		page
CD	15 poles + ⊕	47
CDA	10 poles + ⊕	72
CDC	10 poles + ⊕	73
MIXO	1 module	156+195

Cover versions L and LG cannot be used together with coding pins. If this application is required, please contact ILME SpA.

hoods with single lever



NEW

covers



description	part no.	entry Pg	part no.	entry M	part no.
with lever, top entry	CZV 15 LG	13.5	MZV 15 LG20	20	
with pegs (for 1 lever enclosures)					CZC 15 L

dimensions in mm

CZV LG and MZV LG

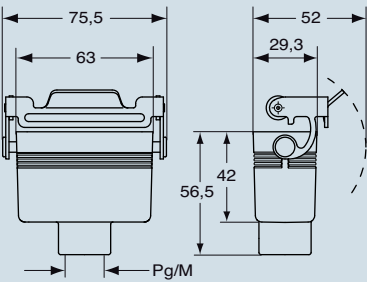

CZC L

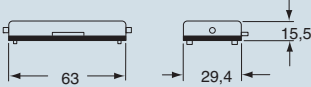

CALUS Type 4/4X/12



dimensions shown are not binding and may be changed without notice



inserts:		page
CD	25 poles + ⊕	48
CDD	38 poles + ⊕	60
CDA	16 poles + ⊕	74
CDC	16 poles + ⊕	75

bulkhead mounting housings
with single lever



surface mounting housings
with single lever



description	part no.	part no.	entry Pg	part no.	entry M
with simple lever	CZI 25 L				
with lever and cover	CZI 25 LS				
with simple lever, high construction		CZAP 25 L	16		
with simple lever, high construction		CZAP 25 L2	16 x 2	MZAP 25 L225	25 x 2
with simple lever, high construction		CZAP 25 L21	21	MZAP 25 L25	25
with simple lever and cover, high		CZAP 25LS221	21 x 2	MZAP 25LS225	25 x 2

panel cut-out for bulkhead mounting housings in mm

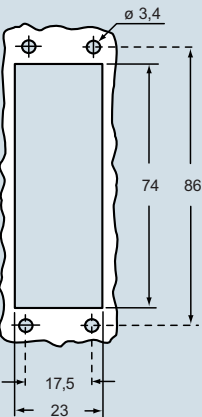

NB: the enclosures ensure IP66 protection (or IP65 for cover versions) rating when mated and locked with the closing levers.

dimensions in mm

CZI L

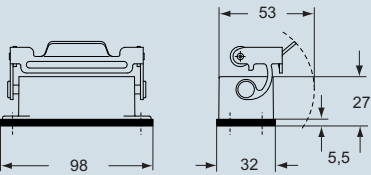

CZI LS

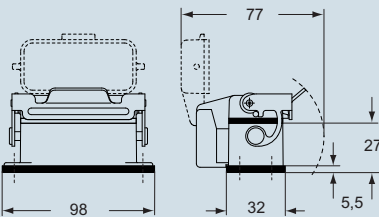

dimensions in mm

CZAP L and MZAP L

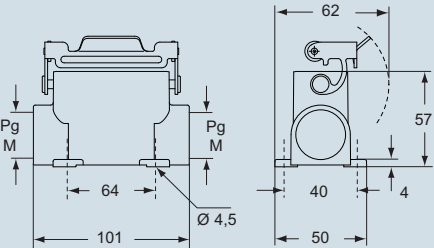

CZAP LS and MZAP LS

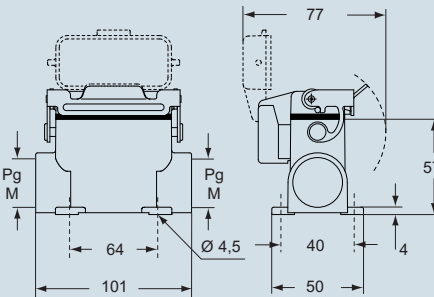

CAV[®] Type
4/4X/12



dimensions shown are not binding
and may be changed without notice

inserts:		page
CD	25 poles + ⊕	48
CDD	38 poles + ⊕	60
CDA	16 poles + ⊕	74
CDC	16 poles + ⊕	75

Cover versions L and LG cannot be used together with coding pins. If this application is required, please contact ILME SpA.

hoods with 2 pegs



hoods with 2 pegs, double top entry



description	part no.	entry Pg	part no.	entry M	part no.	entry Pg	part no.	entry M
with pegs, top entry	CZO 25 L	16	MZO 25 L20	20				
with pegs, top entry			MZO 25 L25	25				
with pegs, top entry, high construction	CZAO 25 L16	16	MZAO 25 L20	20				
with pegs, top entry, high construction	CZAO 25 L21	21	MZAO 25 L25	25				
with pegs, side entry	CZV 25 L	16	MZV 25 L20 **	20				
with pegs, top entry, high construction	CZAV 25 L16	16	MZAV 25 L20	20				
with pegs, top entry, high construction	CZAV 25 L21	21	MZAV 25 L25	25				
with pegs, side entry, high construction, without adaptor *	CZFO 25 L16	16	MZFO 25 L20	20				
with pegs, side entry, high construction, without adaptor *	CZFO 25 L21	21	MZFO 25 L25	25				
with pegs, top entry, high construction, without adaptor *	CZFV 25 L16	16	MZFV 25 L20	20				
with pegs, top entry, high construction, without adaptor *	CZFV 25 L21	21	MZFV 25 L25	25				
with pegs for 1 lever					CZAV 25 L216	16 x 2	MZAV 25 L220	20 x 2
with pegs for 1 lever, without adaptor *					CZFV 25 L216	16 x 2	MZFV 25 L220	20 x 2

* enclosure without adaptor, threaded on the body, to be used only with a complete cable gland.

** can only be used with a complete cable gland (to be purchased separately)

dimensions in mm

CZO L e MZO L

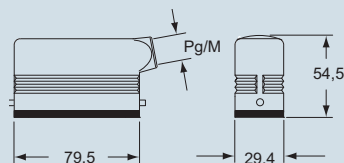

CZAO L - MZAO L and CZAV L - MZAV L

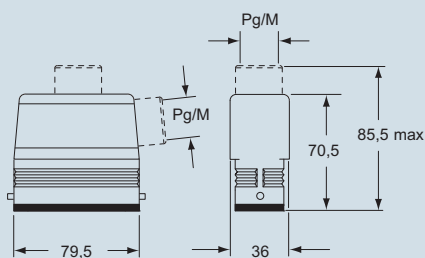

CZV L and MZV L

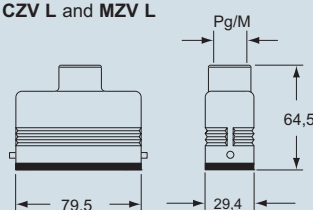

CZFO L - MZFO L and CZFV L - MZFV L

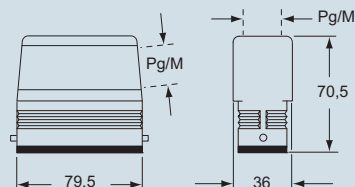

dimensions in mm

CZAV/CZFV L2 and (MZAV)/MZFV L2

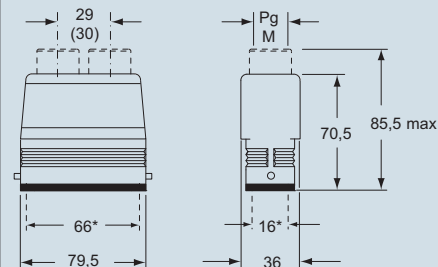

CALUS® Type
4/4X/12



dimensions shown are not binding
and may be changed without notice



inserts:		page
CD	25 poles + ⊕	48
CDD	38 poles + ⊕	60
CDA	16 poles + ⊕	74
CDC	16 poles + ⊕	75

Cover versions L and LG cannot be used together with coding pins. If this application is required, please contact ILME SpA.

hoods with single lever



NEW

covers

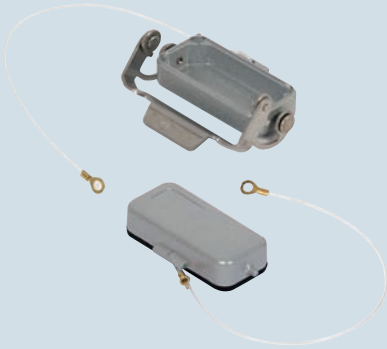

description	part no.	entry Pg	part no.	entry M	part no.
with lever, top entry	CZV 25 LG	16	MZV 25 LG20	20	
with pegs (for 1 lever enclosures)					CZC 25 L
with simple lever (for enclosures with pegs)					CZC 25 LG

dimensions in mm

CZV LG and MZV LG

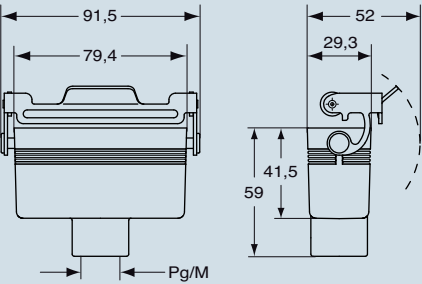

CZAO L - MZAO L and CZAV L - MZAV L

dimensions in mm

CZC L

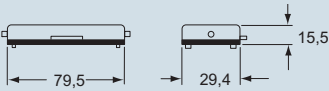

CZC LG

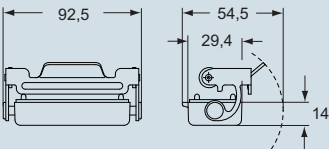

CALUS[®] Type 4/4X/12



dimensions shown are not binding and may be changed without notice



inserts:		page
CD	50 poles + ⊕	50
CDD	76 poles + ⊕	63
CDA	32 poles + ⊕	76
CDC	32 poles + ⊕	77

insert dimensions:
2 x (66 x 16) mm

bulkhead mounting housings with 2 levers or 4 pegs



surface mounting housings with 2 levers or 4 pegs



description	part no.	part no.	entry Pg	part no.	entry M
con leve	CHI 50				
with pegs and cover ¹⁾	CHI 50 CS				
with levers		CHP 50.21	21	MHP 50.32	32
with levers		CHP 50.221	21 x 2	MHP 50.232	32 x 2
with levers		CHP 50.29	29	MHP 50.40	40
with levers		CHP 50.229	29 x 2	MHP 50.240	40 x 2
with pegs and cover ¹⁾		CHP 50 CS	21	MHP 50 CS32	32
with pegs and cover ¹⁾		CHP 50 CS2	21 x 2	MHP 50 CS232	32 x 2
with pegs and cover ¹⁾		CHP 50 CS29	29	MHP 50 CS40	40
with pegs and cover ¹⁾		CHP 50 CS229	29 x 2	MHP 50 CS240	40 x 2

¹⁾ may be combined with enclosures:
- CHO/CAO 50 X and CAV 50 X
- MHO/MAO/MFO 50 X and MAV/MFV 50 X

NB: the enclosures ensure IP66 protection (or IP65 for cover versions) rating when mated and locked with the closing levers.
The cover (CS, CP) only ensures mechanical protection, but does not ensure IP65 protection rating.

panel cut-out for bulkhead mounting housings in mm

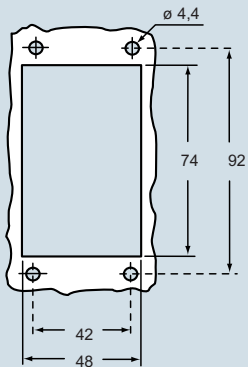

dimensions in mm

CHI

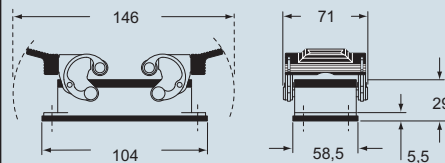

CHI CS

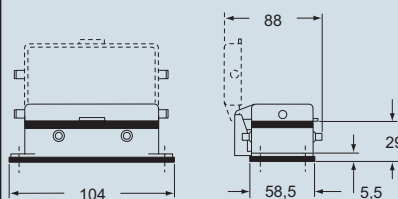

dimensions in mm

CHP and MHP

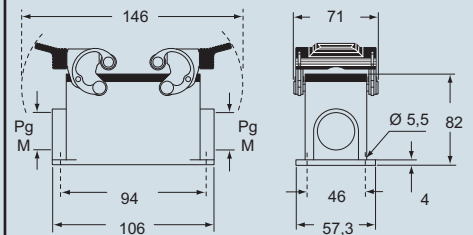

CHP CS and MHP CS

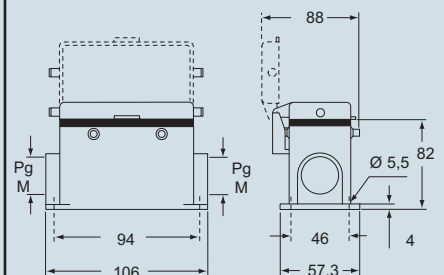

CAV® Type
4/4X/12



dimensions shown are not binding
and may be changed without notice

inserts:		page
CD	50 poles + ⊕	50
CDD	76 poles + ⊕	63
CDA	32 poles + ⊕	76
CDC	32 poles + ⊕	77

insert dimensions:
2 x (66 x 16) mm

hoods with 4 pegs



hoods with 4 pegs



description	part no.	entry Pg	part no.	entry M	part no.	entry Pg	part no.	entry M
with pegs, side entry	CHO 50	21	MHO 50.25	25				
with pegs, side entry			MHO 50.32	32				
with pegs, side entry, high construction	CAO 50.21	21	MAO 50.25	25				
with pegs, side entry, high construction	CAO 50.29	29	MAO 50.32	32				
with pegs, top entry, high construction					CAV 50.21	21	MAV 50.25	25
with pegs, top entry, high construction					CAV 50.29	29	MAV 50.32	32
with levers and gasket, top entry, high construction					CAV 50 G29	29	MAV 50 G32	32
with pegs, side entry, high construction, without adaptor *	CFO 50.21	21	MFO 50.25	25				
with pegs, side entry, high construction, without adaptor *	CFO 50.29	29	MFO 50.32	32				
with pegs, top entry, high construction, without adaptor *					CFV 50.21	21	MFV 50.25	25
with pegs, top entry, high construction, without adaptor *					CFV 50.29	29	MFV 50.32	32
with levers and gasket, top entry, high, without adaptor *					CFV 50 G29	29	MFV 50 G32	32

* enclosure without adaptor, threaded on the body, to be used only with a complete cable gland.

dimensions in mm

CHO (CAO/CFO) and MHO (MAO/MFO)

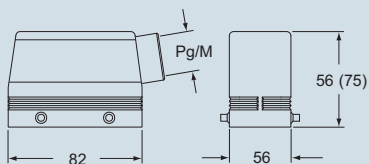

dimensions in mm

CAV (CFV) and MAV (MFV)

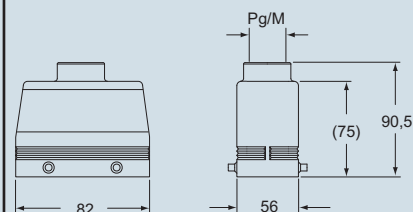

CAV G (CFV G) and MAV G (MFV G)

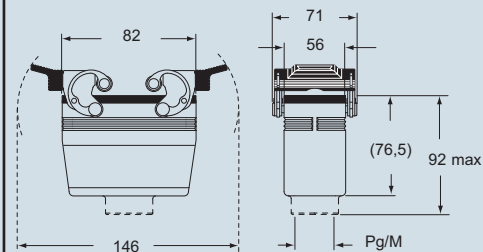

CALUS Type 4/4X/12



dimensions shown are not binding
and may be changed without notice

inserts:		page
CD	50 poles + ⊕	50
CDD	76 poles + ⊕	63
CDA	32 poles + ⊕	76
CDC	32 poles + ⊕	77

insert dimensions:
2 x (66 x 16) mm

CHC 50 and CHC 50 G covers cannot be used together with coding pins. If this application is required, please contact ILME SpA.

hoods with 4 pegs



covers

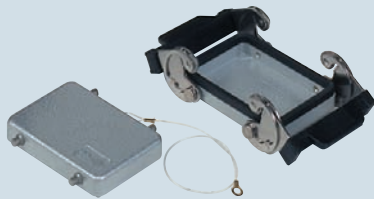

description	part no.	entry Pg	part no.	entry M	part no.
with levers, side entry ¹⁾	CHO 50 X	21	MHO 50 X25	25	
with levers, side entry ¹⁾			MHO 50 X32	32	
with levers, side entry, high construction ¹⁾	CAO 50 X	21	MAO 50 X25	25	
with levers, side entry, high construction ¹⁾	CAO 50 X29	29	MAO 50 X32	32	
with levers, top entry, high construction ¹⁾	CAV 50 X	21	MAV 50 X25	25	
with levers, top entry, high construction ¹⁾	CAV 50 X29	29	MAV 50 X32	32	
with levers, side entry, high construction, without adaptor ^{1)*}	CFO 50 X	21	MFO 50 X25	25	
with levers, side entry, high construction, without adaptor ^{1)*}	CFO 50 X29	29	MFO 50 X32	32	
with levers, top entry, high construction, without adaptor ^{1)*}	CFV 50 X	21	MFV 50 X25	25	
with levers, top entry, high construction, without adaptor ^{1)*}	CFV 50 X29	29	MFV 50 X32	32	
with 4 pegs (for enclosures with 2 levers)					CHC 50
with 2 levers (for hoods with 4 pegs)					CHC 50 G

¹⁾ may be combined with enclosures:
- CHI 50 CS, CHP 50 CS and MHP 50 CS

* enclosure without adaptor, threaded on the body, to enclosure to be used only with a complete cable gland.

dimensions in mm

CHO X (CAO X/CFO X) and MHO X (MAO X/MFO X)

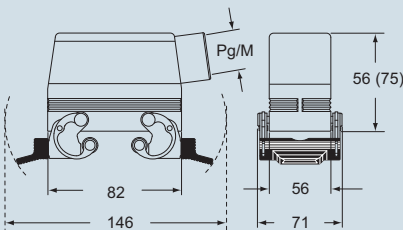

CAV X (CFV X) and MAV X (MFV X)

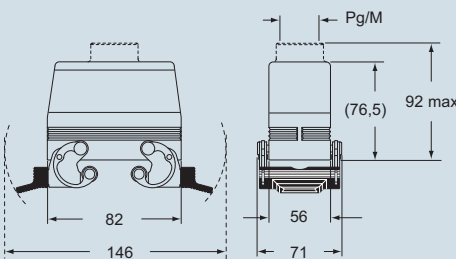

dimensions in mm

CHC



CHC G

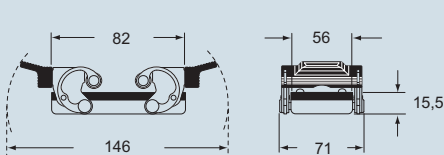

CALUS Type 4/4X/12



dimensions shown are not binding
and may be changed without notice

inserts:		page
CDD	24 poles + ⊕	59
CQE	10 poles + ⊕	80
CSH	6 poles + ⊕	88
CCE	6 poles + ⊕	94
CNE, CSE, JCNE, JCSE	6 poles + ⊕	95 and 106
CSS	6 poles + ⊕	118
CT, CTE, CTSE	6 poles + ⊕	126 and 130
MIXO	2 modules	156÷195

insert centre distance:
44 x 27 mm

bulkhead mounting housings with single lever

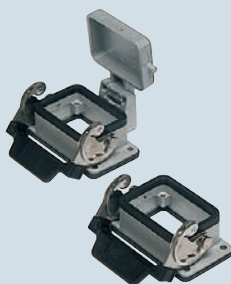

bulkhead mounting housings with single lever



description

part
no.

part
no.

con leva

CHI 06 L

with lever and cover

CHI 06 LS

with pegs ¹⁾

CHI 06 LC

with pegs and aluminum cover ¹⁾

CHI 06 LCS

with pegs and plastic cover ¹⁾

CHI 06 LCP

¹⁾ may be combined with enclosures:

- CHO/CHV 06 LX
- CHO/CHV 06 LX

NB: the enclosures ensure IP66 protection (or IP65 for cover versions) rating when mated and locked with the closing levers.

The door (CS, CP) only ensures mechanical protection, but does not ensure IP65 protection rating.

panel cut-out for bulkhead mounting housings in mm

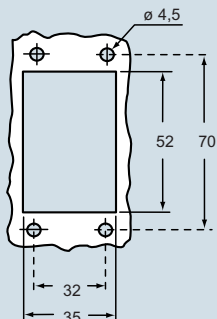

dimensions in mm

CHI L

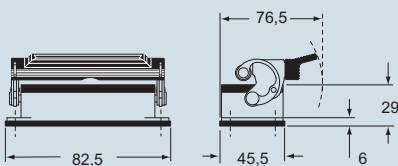

CHI LS

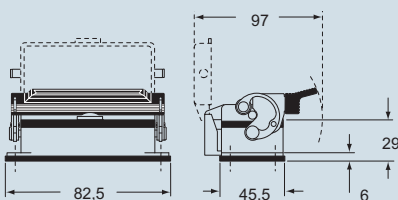

dimensions in mm

CHI LC

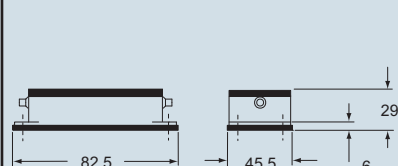

CHI LCS/LCP

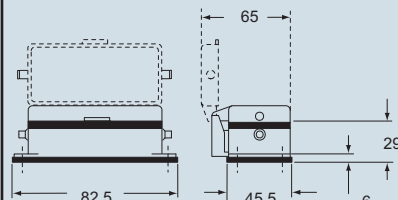

CALUS® Type
4/4X/12

(excluding enclosures with plastic cover)



dimensions shown are not binding
and may be changed without notice

inserts:		page
CDD	24 poles + ⊕	59
CQE	10 poles + ⊕	80
CSH	6 poles + ⊕	88
CCE	6 poles + ⊕	94
CNE, CSE, JCNE, JCSE	6 poles + ⊕	95 and 106
CSS	6 poles + ⊕	108
MIXO	2 modules	156+195

insert centre distance:
44 x 27 mm

surface mounting housings with single lever



angled surface mounting housings with single lever



description	part no.	entry Pg	part no.	entry M	part no.	entry M
with lever	CHP 06 L	16	MHP 06 L20	20		
with lever	CHP 06 L2	16 x 2	MHP 06 L220	20 x 2		
with lever, high	CAP 06 L	21	MAP 06 L32	32		
with lever, high	CAP 06 L2	21 x 2	MAP 06 L232	32 x 2		
with lever, high	CAP 06 L29	29	MAP 06 L40	40		
with lever, high	CAP 06 L229	29 x 2	MAP 06 L240	40 x 2		
with lever and cover	CHP 06 LS	16	MHP 06 LS20	20		
with lever and cover	CHP 06 LS2	16 x 2	MHP 06 LS220	20 x 2		
with lever and cover, high	CAP 06 LS	21	MAP 06 LS32	32		
with lever and cover, high	CAP 06 LS2	21 x 2	MAP 06 LS232	32 x 2		
with lever and cover, high	CAP 06 LS29	29	MAP 06 LS40	40		
with lever and cover, high	CAP 06 LS229	29 x 2	MAP 06 LS240	40 x 2		
with lever, cable gland entry, closed bulkhead *					MAV 06LG25-F	M25

NB: the enclosures ensure IP66 protection (or IP65 for cover versions) rating when mated and locked with the closing levers.
 The door (CS, CP) only ensures mechanical protection, but does not ensure IP65 protection rating.

* be used only with a complete cable gland.
 (to be purchased separately).
 * versions with M32, Pg 21 or Pg 29 entry on request

dimensions in mm

CHP L - CAP L and MHP L - MAP L

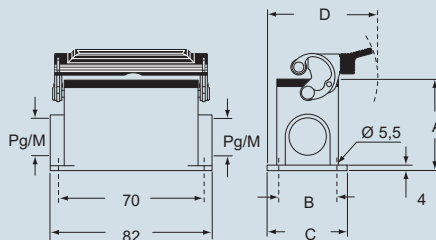

CHP LS - CAP LS and MHP LS - MAP LS

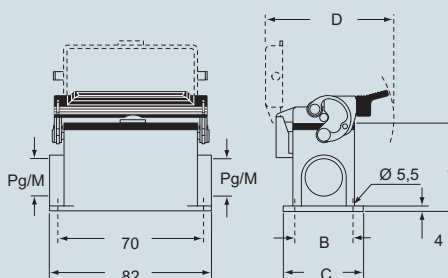

type	A	B	C	D
CHP L / MHP L	53	40	52	73.5
CAP L / MAP L	74	45	57	82
CHP LS / MHP LS	53	40	52	97
CAP LS / MAP LS	74	45	57	97

dimensions in mm

MAV 06LG25-F

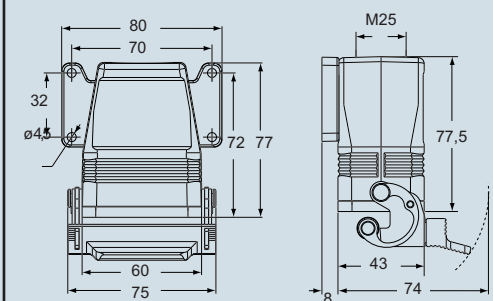

CALUS® Type
 4/4X/12



dimensions shown are not binding
 and may be changed without notice

inserts:		page
CDD	24 poles + ⊕	59
CQE	10 poles + ⊕	80
CSH	6 poles + ⊕	88
CNE, CSE, JCNE, JCSE	6 poles + ⊕ 95 and 106	
CSS	6 poles + ⊕	118
MIXO	2 modules	156+195

insert centre distance:
44 x 27 mm

hoods with 2 pegs



hoods with 2 pegs



description	part no.	entry Pg	part no.	entry M	part no.	entry Pg	part no.	entry M
with pegs, side entry	CHO 06 L13	13.5	MHO 06 L20	20				
with pegs, side entry	CHO 06 L16	16	MHO 06 L25	25				
with pegs, side entry, high construction	CAO 06 L21	21	MAO 06 L25	25				
with pegs, side entry, high construction	CAO 06 L29	29	MAO 06 L32	32				
with pegs, side entry, high construction, without adaptor *	CFO 06 L21	21	MFO 06 L25	25				
with pegs, side entry, high construction, without adaptor *	CFO 06 L29	29	MFO 06 L32	32				
with pegs, side entry	CHV 06 L13	13.5	MHV 06 L20	20				
with pegs, side entry	CHV 06 L16	16	MHV 06 L25	25				
with pegs, top entry, high construction	CAV 06 L21	21	MAV 06 L25	25				
with pegs, top entry, high construction	CAV 06 L29	29	MAV 06 L32	32				
with pegs, top entry, high construction, without adaptor *	CFV 06 L21	21	MFV 06 L25	25				
with pegs, top entry, high construction, without adaptor *	CFV 06 L29	29	MFV 06 L32	32				
with lever, top entry					CHV 06 LG	16	MHV 06 LG25	25
with lever, top entry, high construction					CAV 06 LG21	21	MAV 06 LG25	25
with lever, top entry, high construction					CAV 06 LG29	29	MAV 06 LG32	32
with lever, top entry, high construction, without adaptor *					CFV 06 LG21	21	MFV 06 LG25	25
with lever, top entry, high construction, without adaptor *					CFV 06 LG29	29	MFV 06 LG32	32

* enclosure without adaptor, threaded on the body, to enclosure to be used only with a complete cable gland.

dimensions in mm

CHO L (CAO L) and (CFO L)
MHO L (MAO L) and (MFO L)

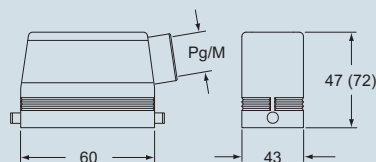

CHV L (CAV L) and [CFV L]
MHV L (MAV L) and [MFV L]

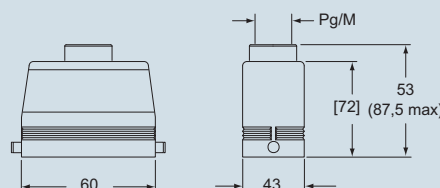

dimensions in mm

CHV LG (CAV LG) and [CFV LG]
MHV LG (MAV LG) and [MFV LG]

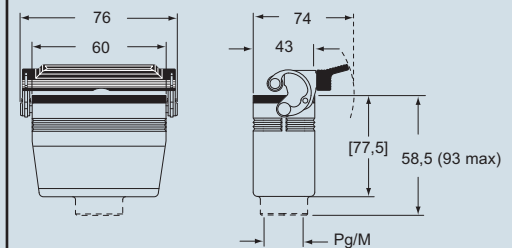

CALUS® Type
4/4X/12



according to the type of lever

dimensions shown are not binding
and may be changed without notice

inserts:		page
CDD	24 poles + ⊕	59
CQE	10 poles + ⊕	80
CSH	6 poles + ⊕	88
CCE	6 poles + ⊕	94
CNE, CSE, JCNE, JCSE	6 poles + ⊕ 95 and 106	
CSS	6 poles + ⊕	118
CT, CTE, CTSE	6 poles + ⊕ 126 and 130	
MIXO	2 modules	156÷195

insert centre distance:
44 x 27 mm

hoods with 1 lever



covers



description	part no.	entry Pg	part no.	entry M	part no.
with lever, without gasket, side entry ¹⁾	CHO 06 LX16	16	MHO 06 LX20	20	
with lever, without gasket, side entry ¹⁾			MHO 06 LX25	25	
with lever, without gasket, top entry ¹⁾	CHV 06 LX16	16	MHV 06 LX20	20	
with lever, without gasket, top entry ¹⁾			MHV 06 LX25	25	
with lever (for hoods with pegs)					CHC 06 LG
with pegs (for enclosures with lever)					CHC 06 L
with pegs and gasket (for hoods with lever) ²⁾					CHC 06 LC

¹⁾ may be combined with enclosures: CHI 06 LCS/LCP/LC

²⁾ may be combined with enclosures:

- CHO/CHV 06 LX
- CHO/CHV 06 LX

dimensions in mm

CHO LX and MHO LX

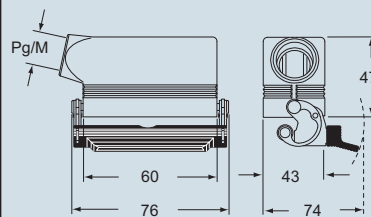

CHV LX and MHV LX

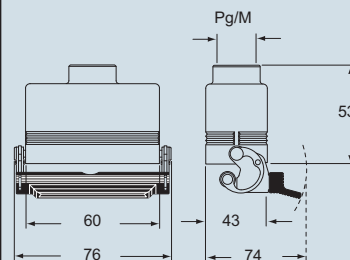

dimensions in mm

CHC LG

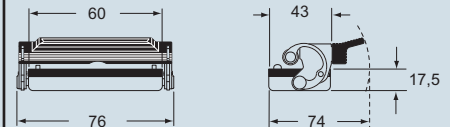

CHC L

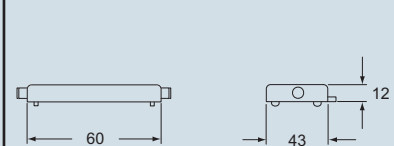

CHC LC



CALUS Type
 4/4X/12



dimensions shown are not binding
 and may be changed without notice

inserts:		page
CDD	42 poles + ⊕	61
CQE	18 poles + ⊕	81
CSH	10 poles + ⊕	89
CCE	10 poles + ⊕	96
CNE, CSE, JCNE, JCSE	10 poles + ⊕ 97 and 107	
CSS	10 poles + ⊕	119
CT, CTE, CTSE	10 poles + ⊕ 127 and 131	
CMSE	3+2 (aux) poles + ⊕	135
CMCE	3+2 (aux) poles + ⊕	134
CX	8/24 poles + ⊕	151
MIXO	3 modules	156÷195

insert centre distance:
57 x 27 mm

bulkhead mounting housings with 2 levers or 4 pegs



bulkhead mounting housings with single lever



description	part no.	part no.
with one or two levers	CHI 10	CHI 10 L
with pegs ¹⁾	CHI 10 C	
with pegs and aluminum cover ¹⁾	CHI 10 CS	
with pegs and plastic cover ¹⁾	CHI 10 CP	
with lever and cover		CHI 10 LS

¹⁾ may be combined with enclosures:
- CHO/CAO 10 X and CHV/CAV 10 X
- MHO/MAO 10 X and MHV/MAV 10 X

NB: the enclosures ensure IP66 protection (or IP65 for cover versions) rating when mated and locked with the closing levers.

The door (CS, CP) only ensures mechanical protection, but does not ensure IP65 protection rating.

panel cut-out for bulkhead mounting housings in mm

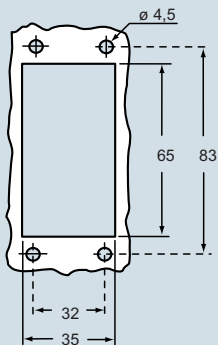

dimensions in mm

CHI

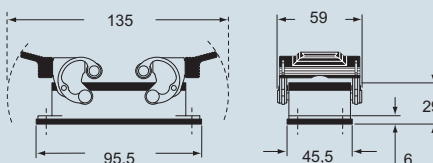

CHI C

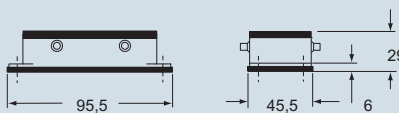

CHI CS/CP

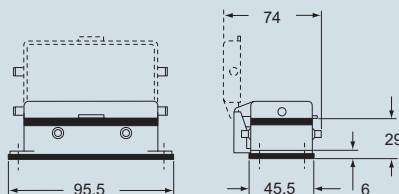

dimensions in mm

CHI L

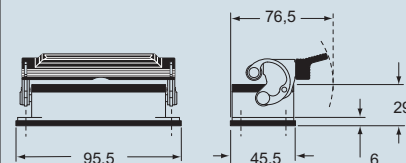

CHI LS

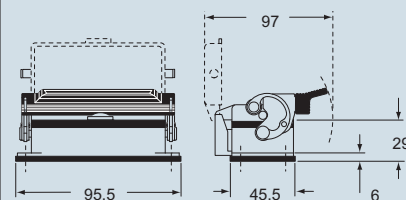

CALUS Type
4/4X/12

(excluding enclosures with plastic cover)



dimensions shown are not binding
and may be changed without notice

inserts:		page
CDD	42 poles + ⊕	61
CQE	18 poles + ⊕	81
CSH	10 poles + ⊕	89
CCE	10 poles + ⊕	96
CNE, CSE, JCNE, JCSE	10 poles + ⊕ 97 and 107	
CSS	10 poles + ⊕	119
CMSE	3+2 (aux) poles + ⊕	135
CMCE	3+2 (aux) poles + ⊕	134
CX	8/24 poles + ⊕	151
MIXO	3 modules	156÷195

insert centre distance:
57 x 27 mm

surface mounting housings with 2 levers or 4 pegs



surface mounting housings with single lever



description	part no.	entry Pg	part no.	entry M	part no.	entry Pg	part no.	entry M
with levers	CHP 10	16	MHP 10.20	20	CHP 10 L	16	MHP 10 L20	20
with levers	CHP 10.2	16 x 2	MHP 10.220	20 x 2	CHP 10 L2	16 x 2	MHP 10 L220	20 x 2
with levers, high	CAP 10.21	21	MAP 10.32	32	CAP 10 L	21	MAP 10 L32	32
with levers, high	CAP 10.221	21 x 2	MAP 10.232	32 x 2	CAP 10 L2	21 x 2	MAP 10 L232	32 x 2
with levers, high	CAP 10.29	29	MAP 10.40	40	CAP 10 L29	29	MAP 10 L40	40
with levers, high	CAP 10.229	29 x 2	MAP 10.240	40 x 2	CAP 10 L229	29 x 2	MAP 10 L240	40 x 2
with pegs and aluminum cover ¹⁾	CHP 10 CS	16	MHP 10 CS20	20				
with pegs and aluminum cover ¹⁾	CHP 10 CS2	16 x 2	MHP 10 CS220	20 x 2				
with pegs and aluminum cover, high ¹⁾	CAP 10 CS	21	MAP 10 CS32	32				
with pegs and aluminum cover, high ¹⁾	CAP 10 CS2	21 x 2	MAP 10 CS232	32 x 2				
with pegs and aluminum cover, high ¹⁾	CAP 10 CS29	29	MAP 10 CS40	40				
with pegs and aluminum cover, high ¹⁾	CAP 10 CS229	29 x 2	MAP 10 CS240	40 x 2				
with pegs and plastic cover ¹⁾	CHP 10 CP	16	MHP 10 CP20	20				
with pegs and plastic cover ¹⁾	CHP 10 CP2	16 x 2	MHP 10 CP220	20 x 2				
with pegs and plastic cover, high ¹⁾	CAP 10 CP	21	MAP 10 CP32	32				
with pegs and plastic cover, high ¹⁾	CAP 10 CP2	21 x 2	MAP 10 CP232	32 x 2				
with pegs and plastic cover, high ¹⁾	CAP 10 CP29	29	MAP 10 CP40	40				
with pegs and plastic cover, high ¹⁾	CAP 10 CP229	29 x 2	MAP 10 CP240	40 x 2				
with lever and cover					CHP 10 LS	16	MHP 10 LS20	20
with lever and cover					CHP 10 LS2	16 x 2	MHP 10 LS220	20 x 2
with lever and cover, high					CAP 10 LS	21	MAP 10 LS32	32
with lever and cover, high					CAP 10 LS2	21 x 2	MAP 10 LS232	32 x 2
with lever and cover, high					CAP 10 LS29	29	MAP 10 LS40	40
with lever and cover, high					CAP 10 LS229	29 x 2	MAP 10 LS240	40 x 2

¹⁾ may be combined with enclosures:
- CHO/CAO 10 X and CHV/CAV 10 X
- MHO/MAO 10 X and MHV/MAV 10 X

NB: the enclosures ensure IP66 protection (or IP65 for cover versions) rating when mated and locked with the closing levers.
The door (CS, CP) only ensures mechanical protection, but does not ensure IP65 protection rating.

dimensions in mm

CHP - CAP and MHP - MAP

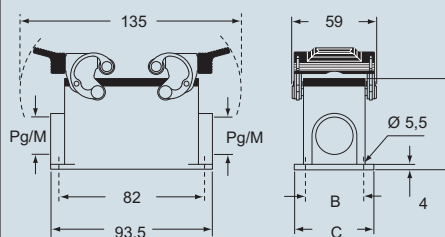

CHP CS/CP - CAP CS/CP and MHP CS/CP - MAP CS/CP

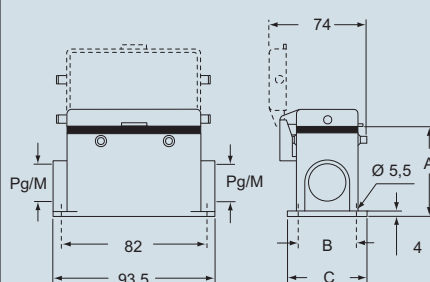

type	A	B	C
CHP / MHP	57	40	52
CAP / MAP	74	45	57
CHP CS / MHP CS	57	40	52
CAP CS / MAP CS	74	45	57
CHP CP / MHP CP	57	40	52
CAP CP / MAP CP	74	45	57

dimensions in mm

CHP L - CAP L and MHP L - MAP L

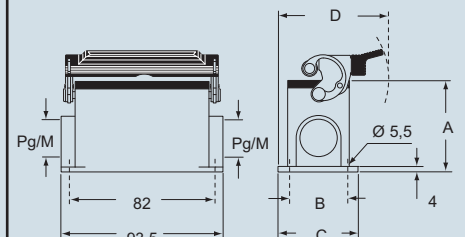

CHP LS - CAP LS and MHP LS - MAP LS

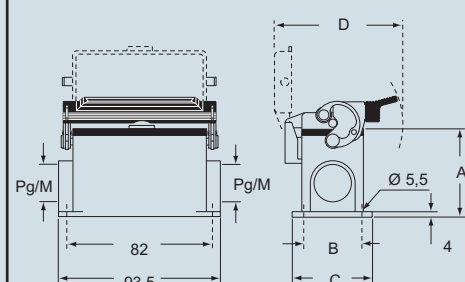

type	A	B	C	D
CHP L / MHP L	57	40	52	79.5
CAP L / MAP L	74	45	57	82
CHP LS / MHP LS	57	40	52	97
CAP LS / MAP LS	74	45	57	97

CAV® Type
4/4X/12

(excluding enclosures with plastic cover)



dimensions shown are not binding
and may be changed without notice

inserts:		page
CDD	42 poles + ⊕	61
CQE	18 poles + ⊕	81
CSH	10 poles + ⊕	89
CCE	10 poles + ⊕	96
CNE, CSE, JCNE, JCSE	10 poles + ⊕	97 and 107
CSS	10 poles + ⊕	119
CMSE	3+2 (aux) poles + ⊕	135
CMCE	3+2 (aux) poles + ⊕	134
CX	8/24 poles + ⊕	129
MIXO	3 modules	156÷195

insert centre distance:
57 x 27 mm

hoods with 4 pegs



hoods with 2 pegs



description	part no.	entry Pg	part no.	entry M	part no.	entry Pg	part no.	entry M
with pegs, side entry	CHO 10	16	MHO 10.20	20	CHO 10 L	16	MHO 10 L20	20
with pegs, side entry			MHO 10.25	25			MHO 10 L25	25
with pegs, side entry, high construction	CAO 10.21	21	MAO 10.32	32	CAO 10 L21	21	MAO 10 L32	32
with pegs, side entry, high construction	CAO 10.29	29	MAO 10.40	40	CAO 10 L29	29	MAO 10 L40	40
with pegs, top entry	CHV 10	16	MHV 10.20 **	20	CHV 10 L	16	MHV 10 L20 **	20
with pegs, top entry			MHV 10.25	25			MHV 10 L25	25
with pegs, top entry, high construction	CAV 10.21	21	MAV 10.32	32	CAV 10 L21	21	MAV 10 L32	32
with pegs, top entry, high construction	CAV 10.29	29	MAV 10.40	40	CAV 10 L29	29	MAV 10 L40	40
with pegs, frontal entry, high construction	CAF 10	16	MAF 10.20	20				
with pegs, frontal entry, high constr., without adaptor *	CFF 10	16	MFF 10.20	20				

* be used only with a complete cable gland

** can only be used with a complete cable gland (to be purchased separately)

alternatively, hoods with pegs are coupled with fixed enclosures:
- C7, IP67 stainless steel lever, page 254
- CV, IP66 stainless steel lever, page 260
- JEI, IP66 galvanised steel lever, page 288

enclosure without adaptor, threaded on the body, to

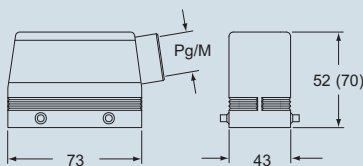
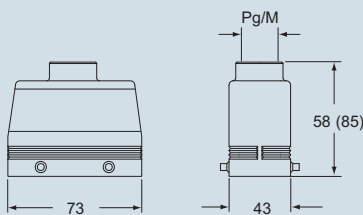
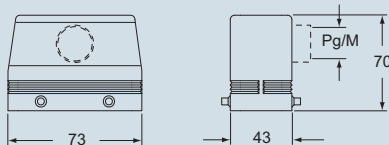
CHO (CAO) and MHO (MAO)**CHV (CAV) and MHV (MAV)****CAF/CFF and MAF/MFF**

dimensions in mm dimensions in mm

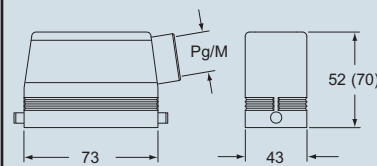
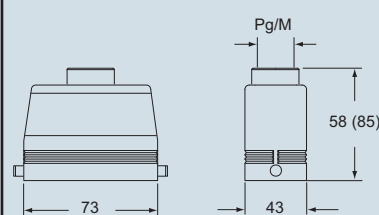
CHO L (CAO L) and MHO L (MAO L)**CHV L (CAV L) and MHV L (MAV L)**

CALUS® Type
4/4X/12



according to the type of lever

dimensions shown are not binding
and may be changed without notice



inserts:		page
CDD	42 poles + ⊕	61
CQE	18 poles + ⊕	81
CSH	10 poles + ⊕	89
CCE	10 poles + ⊕	96
CNE, CSE, JCNE, JCSE	10 poles + ⊕ 97 and 107	
CSS	10 poles + ⊕	119
CMSE	3+2 (aux) poles + ⊕	135
CMCE	3+2 (aux) poles + ⊕	134
CX	8/24 poles + ⊕	129
MIXO	3 modules	156+195

insert centre distance:
57 x 27 mm

hoods with double top entry



description	part no.	entry Pg	part no.	entry M
with pegs for two levers - used with enclosures size "57.27"	CAV 10.213	13.5 x 2	MAV 10.220	20 x 2
with pegs for 2 lever, without adaptor * - used with enclosures size "57.27"	CFV 10.213	13.5 x 2	MFV 10.220	20 x 2

* enclosure without adaptor, threaded on the body, to be used only with a complete cable gland.

dimensions in mm

CAV/CFV and MAV/MFV

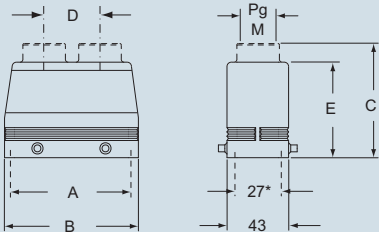

alternatively, hoods with pegs
are coupled with fixed enclosures:
- C7, IP67 stainless steel lever, page 254
- CV, IP66 stainless steel lever, page 260
- JEI, IP66 galvanised steel lever, page 288

part	A	B	C	D	E
CAV 10.213/MAV 10.220	57	73	82 (84.5)	26 (28.5)	70
CFV 10.213/MFV 10.220	57	73	—	28.5 (26)	70

*) screw fixing centre distance

CALUS® Type
4/4X/12



dimensions shown are not binding
and may be changed without notice



inserts:		page
CDD	42 poles + ⊕	61
CQE	18 poles + ⊕	81
CSH	10 poles + ⊕	89
CCE	10 poles + ⊕	96
CNE, CSE, JCNE, JCSE	poles + ⊕ 97 and 107	
CSS	10 poles + ⊕	119
CMSE	3+2 (aux) poles + ⊕	135
CMCE	3+2 (aux) poles + ⊕	134
CX	8/24 poles + ⊕	129
MIXO	3 modules	156÷195

insert centre distance:
57 x 27 mm

hoods with 2 levers



hoods with 1 lever



description	part no.	entry Pg	part no.	entry M	part no.	entry Pg	part no.	entry M
with levers and gasket, top entry	CHV 10 G	16	MHV 10 G25	25	CHV 10 LG	16	MHV 10 LG25	25
with levers and gasket, top entry, high construction	CAV 10 G	21	MAV 10 G25	25	CAV 10 LG21	21	MAV 10 LG25	25
with levers and gasket, top entry, high construction	CAV 10 G29	29	MAV 10 G32	32	CAV 10 LG29	29	MAV 10 LG32	32
with levers and gasket, top entry, high construction, without adaptor*	CFV 10 G	21	MFV 10 G25	25	CFV 10 LG21	21	MFV 10 LG25	25
with levers and gasket, top entry, high construction, without adaptor*	CFV 10 G29	29	MFV 10 G32	32	CFV 10 LG29	29	MFV 10 LG32	32

* enclosure without adaptor, threaded on the body, to be used only with a complete cable gland.

dimensions in mm

CHV G (CAV G) and [CFV G],
MHV G (MAV G) and [MFV G]

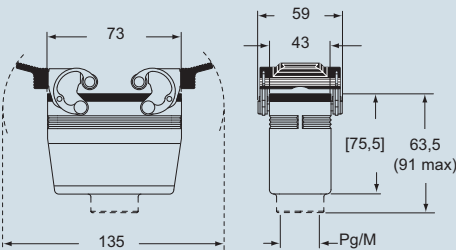

dimensions in mm

CHV LG (CAV LG) and [CFV LG],
MHV LG (MAV LG) and [MFV LG]

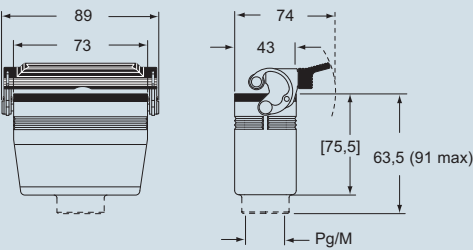

CALUS Type
4/4X/12



dimensions shown are not binding
and may be changed without notice

inserts:		page
CDD	42 poles + ⊕	61
CQE	18 poles + ⊕	81
CSH	10 poles + ⊕	89
CCE	10 poles + ⊕	96
CNE, CSE, JCNE, JCSE	10 poles + ⊕	97 and 107
CSS	10 poles + ⊕	119
CMSE	3+2 (aux) poles + ⊕	135
CMCE	3+2 (aux) poles + ⊕	134
CX	8/24 poles + ⊕	129
MIXO	3 modules	156+195

insert centre distance: 57 x 27 mm

hoods with 2 levers

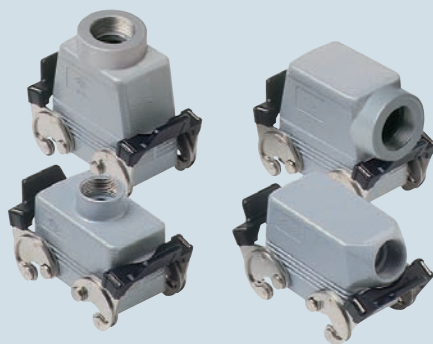

covers

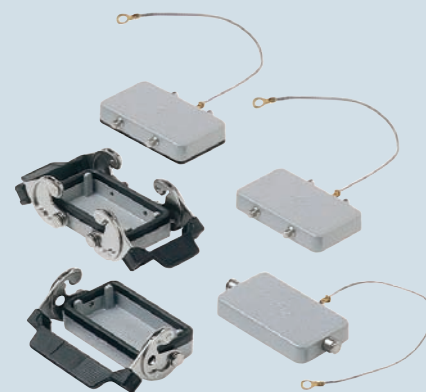

description	part no.	entry Pg	part no.	entry M	part no.
with levers, side entry ¹⁾	CHO 10 X	16	MHO 10 X20	20	
with levers, side entry ¹⁾			MHO 10 X25	25	
with levers, side entry, high construction ¹⁾	CAO 10 X	21	MAO 10 X32	32	
with levers, side entry, high construction ¹⁾	CAO 10 X29	29	MAO 10 X40	40	
with levers, top entry ¹⁾	CHV 10 X	16	MHV 10 X20 **	20	
with levers, top entry ¹⁾			MHV 10 X25	25	
with levers, top entry, high ¹⁾	CAV 10 X	21	MAV 10 X32	32	
with levers, top entry, high ¹⁾	CAV 10 X29	29	MAV 10 X40	40	
with 4 pegs (for enclosures with 2 levers with gasket)					CHC 10
with 4 pegs and gasket (for enclosures with 2 levers) ²⁾					CHC 10 C
with 2 pegs (for enclosures with 1 lever with gasket)					CHC 10 L
with 2 levers (for hoods with 4 pegs)					CHC 10 G
with 1 lever (for hoods with 2 pegs)					CHC 10 LG

¹⁾ may be combined with enclosures:

- CHI/CHP/CAP 10 CS/CP/C
- MHP/MAP 10 CS/CP

²⁾ may be combined with enclosures:

- CHO/CAO 10 X and CHV/CAV 10 X
- MHO/MAO 10 X and MHV/MAV 10 X

** can only be used with a complete cable gland (to be purchased separately)

dimensions in mm

CHO X (CAO X) and MHO X (MAO X)

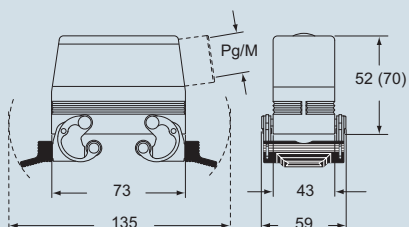

CHV X (CAV X) and MHV X (MAV X)

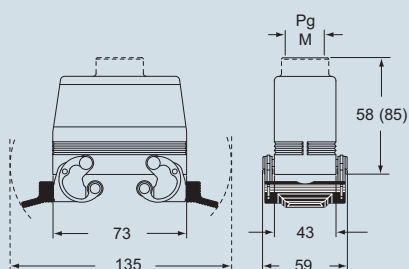

dimensions in mm

CHC



CHC C



CHC L

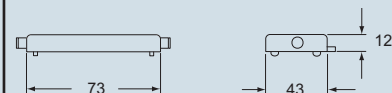

CHC G

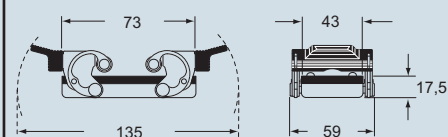

CHC LG

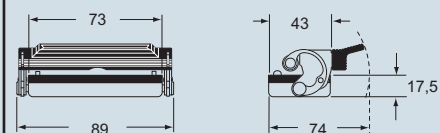

CALUS® Type 4/4X/12



dimensions shown are not binding
and may be changed without notice

inserts:		page
CD	40 poles + ⊕	49
CT, CTS (10A)	40 poles + ⊕	56
CDD	72 poles + ⊕	62
CQE	32 poles + ⊕	82
CSH	16 poles + ⊕	90
CCE	16 poles + ⊕	98
CNE, CSE, JCNE, JCSE	16 poles + ⊕	99 and 108
CSS	16 poles + ⊕	120
CT, CTE, CTSE (16A) ..	16 poles + ⊕	128 and 132
CMSE	6+2 (aux) poles + ⊕	137
CMCE	6+2 (aux) poles + ⊕	136
CP	6 poles + ⊕	149
CX	6/36 and 12/2 poles + ⊕	152+153
CX	4/0 and 4/2 poles + ⊕	154
MIXO	4 modules	156+195

insert centre distance: **77.5 x 27 mm**

description	part no.	part no.
with one or two levers	CHI 16	CHI 16 L
with pegs ¹⁾	CHI 16 C	
with pegs and aluminum cover ¹⁾	CHI 16 CS	
with pegs and plastic cover ¹⁾	CHI 16 CP	
with lever and cover		CHI 16 LS

¹⁾ may be combined with enclosures:
- CHO/CAO 16 X and CHV/CAV 16 X
- MHO/MAO 16 X and MHV/MAV 16 X

NB: the enclosures ensure IP66 protection (or IP65 for cover versions) rating when mated and locked with the closing levers.

The door (CS, CP) only ensures mechanical protection, but does not ensure IP65 protection rating.

panel cut-out for bulkhead mounting housings in mm

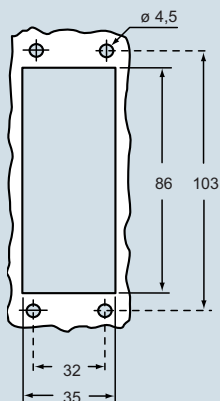

bulkhead mounting housings with 2 levers or 4 pegs



bulkhead mounting housings with single lever



dimensions in mm

CHI

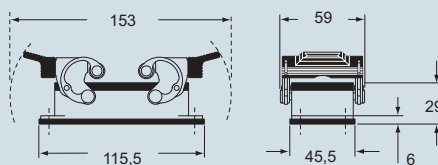

CHI C

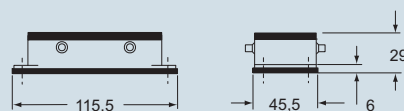

CHI CS/CP

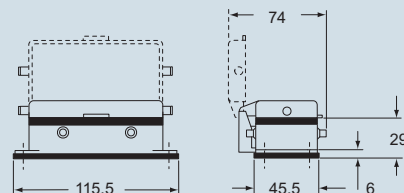

dimensions in mm

CHI L

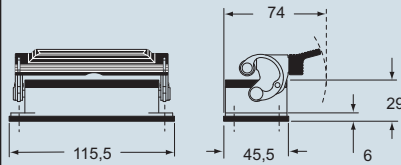

CHI LS

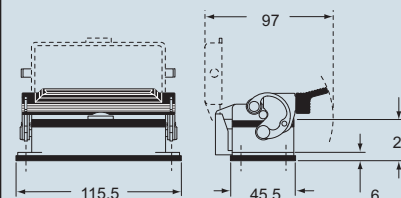

CU® Type
4/4X/12

(excluding enclosures with plastic cover)



dimensions shown are not binding
and may be changed without notice

inserts:		page
CD	40 poles + ⊕	49
CDD	72 poles + ⊕	62
CQE	32 poles + ⊕	82
CSH	16 poles + ⊕	90
CCE	16 poles + ⊕	98
CNE, CSE, JCNE, JCSE	16 poles + ⊕ 99 and 108	
CSS	16 poles + ⊕	120
CMSE	6+2 (aux) poles + ⊕	137
CMCE	6+2 (aux) poles + ⊕	136
CP	6 poles + ⊕	149
CX	6/36 and 12/2 poles + ⊕	152+153
CX	4/0 and 4/2 poles + ⊕	154
MIXO	4 modules	156+195

insert centre distance: 77.5 x 27 mm

surface mounting housings with 2 levers or 4 pegs



surface mounting housings with single lever



description	part no.	entry Pg	part no.	entry M	part no.	entry Pg	part no.	entry M
with levers	CHP 16	21	MHP 16.25	25	CHP 16 L	21	MHP 16 L25	25
with levers	CHP 16.2	21 x 2	MHP 16.225	25 x 2	CHP 16 L2	21 x 2	MHP 16 L225	25 x 2
with levers, high construction	CAP 16.21	21	MAP 16.32	32	CAP 16 L	21	MAP 16 L32	32
with levers, high construction	CAP 16.221	21 x 2	MAP 16.232	32 x 2	CAP 16 L2	21 x 2	MAP 16 L232	32 x 2
with levers, high construction	CAP 16.29	29	MAP 16.40	40	CAP 16 L29	29	MAP 16 L40	40
with levers, high construction	CAP 16.229	29 x 2	MAP 16.240	40 x 2	CAP 16 L229	29 x 2	MAP 16 L240	40 x 2
with pegs and aluminum cover ¹⁾	CHP 16 CS	21	MHP 16 CS25	25				
with lever and aluminum cover ¹⁾	CHP 16 CS2	21 x 2	MHP 16 CS225	25 x 2				
with pegs and aluminum cover, high construction ¹⁾	CAP 16 CS	21	MAP 16 CS32	32				
with pegs and aluminum cover, high construction ¹⁾	CAP 16 CS2	21 x 2	MAP 16 CS232	32 x 2				
with pegs and aluminum cover, high construction ¹⁾	CAP 16 CS29	29	MAP 16 CS40	40				
with pegs and aluminum cover, high construction ¹⁾	CAP 16 CS229	29 x 2	MAP 16 CS240	40 x 2				
with pegs and plastic cover ¹⁾	CHP 16 CP	21	MHP 16 CP25	25				
with pegs and plastic cover ¹⁾	CHP 16 CP2	21 x 2	MHP 16 CP225	25 x 2				
with pegs and plastic cover, high construction ¹⁾	CAP 16 CP	21	MAP 16 CP32	32				
with pegs and plastic cover, high construction ¹⁾	CAP 16 CP2	21 x 2	MAP 16 CP232	32 x 2				
with pegs and plastic cover, high construction ¹⁾	CAP 16 CP29	29	MAP 16 CP40	40				
with pegs and plastic cover, high construction ¹⁾	CAP 16 CP229	29 x 2	MAP 16 CP240	40 x 2				
with lever and cover					CHP 16 LS	21	MHP 16 LS25	25
with lever and cover					CHP 16 LS2	21 x 2	MHP 16 LS225	25 x 2
with lever and cover, high construction					CAP 16 LS	21	MAP 16 LS32	32
with lever and cover, high construction					CAP 16 LS2	21 x 2	MAP 16 LS232	32 x 2
with lever and cover, high construction					CAP 16 LS29	29	MAP 16 LS40	40
with lever and cover, high construction					CAP 16 LS229	29 x 2	MAP 16 LS240	40 x 2

¹⁾ may be combined with enclosures:
- CHO/CAO 16 X and CHV/CAV 16 X
- MHO/MAO 16 X and MHV/MAV 16 X

NB: the enclosures ensure IP66 protection (or IP65 for cover versions) rating when mated and locked with the closing levers.
The door (CS, CP) only ensures mechanical protection, but does not ensure IP65 protection rating.

dimensions in mm

CHP - CAP and MHP - MAP

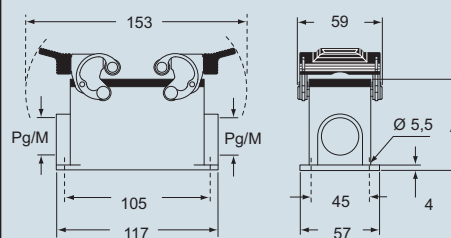

CHP CS/CP - CAP CS/CP and MHP CS/CP - MAP CS/CP

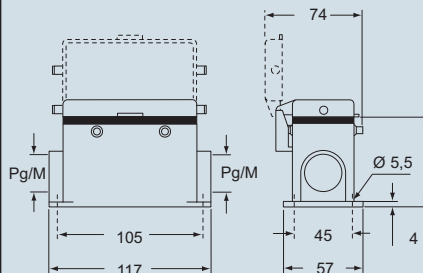

type	A
CHP / MHP	63
CAP / MAP	81
CHP CS / MHP CS	63
CAP CS / MAP CS	81
CHP CP / MHP CP	63
CAP CP / MAP CP	81

dimensions in mm

CHP L - CAP L and MHP L - MAP L

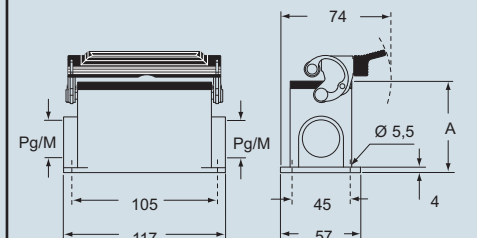

CHP LS - CAP LS and MHP LS - MAP LS

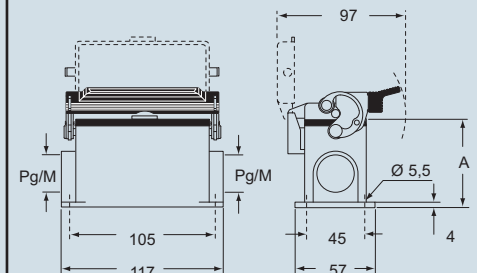

type	A
CHP L / MHP L	63
CAP L / MAP L	81
CHP LS / MHP LS	63
CAP LS / MAP LS	81

CAV® Type
4/4X/12

(excluding enclosures with plastic cover)



dimensions shown are not binding
and may be changed without notice

inserts:		page
CD	40 poles + ⊕	49
CDD	72 poles + ⊕	62
CQE	32 poles + ⊕	82
CSH	16 poles + ⊕	90
CCE	16 poles + ⊕	98
CNE, CSE, JCNE, JCSE	16 poles + ⊕	99 and 108
CSS	16 poles + ⊕	120
CMSE	6+2 (aux) poles + ⊕	137
CMCE	6+2 (aux) poles + ⊕	136
CP	6 poles + ⊕	149
CX	6/36 and 12/2 poles + ⊕	152÷153
CX	4/0 and 4/2 poles + ⊕	154
MIXO	4 modules	156÷195

insert centre distance: 77.5 x 27 mm

hoods with 4 pegs



hoods with 2 pegs



description	part no.	entry Pg	part no.	entry M	part no.	entry Pg	part no.	entry M
with pegs, side entry	CHO 16	21	MHO 16.25	25	CHO 16 L	21	MHO 16 L25	25
with pegs, side entry			MHO 16.32	32			MHO 16 L32	32
with pegs, side entry, high construction	CAO 16.21	21	MAO 16.32	32	CAO 16 L21	21	MAO 16 L32	32
with pegs, side entry, high construction	CAO 16.29	29	MAO 16.40	40	CAO 16 L29	29	MAO 16 L40	40
with pegs, top entry	CHV 16	21	MHV 16.25 **	25	CHV 16 L	21	MHV 16 L25	25
with pegs, top entry			MHV 16.32	32			MHV 16 L32	32
with pegs, top entry, high construction	CAV 16.21	21	MAV 16.32	32	CAV 16 L21	21	MAV 16 L32	32
with pegs, top entry, high construction	CAV 16.29	29	MAV 16.40	40	CAV 16 L29	29	MAV 16 L40	40
with pegs, frontal entry, high construction	CAF 16	21	MAF 16.25	25				
with pegs, frontal entry, high constr., without adaptor *	CFF 16	21	MFF 16.25	25				

* enclosure without adaptor, threaded on the body, to be used only with a complete cable gland.

** can only be used with a complete cable gland (to be purchased separately)

dimensions in mm

CHO (CAO) and MHO (MAO)

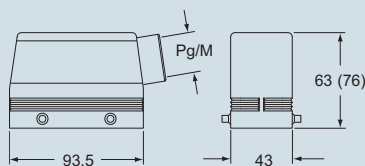

dimensions in mm

CHO L (CAO L) and MHO L (MAO L)

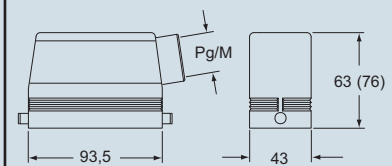

alternatively, hoods with pegs are coupled with fixed enclosures:

- C7, IP67 stainless steel lever, page 254
- CV, IP66 stainless steel lever, page 260
- JEI, IP66 galvanised steel lever, page 288

CHV (CAV) and MHV (MAV)

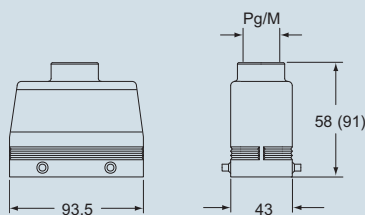

CHV L (CAV L) and MHV L (MAV L)

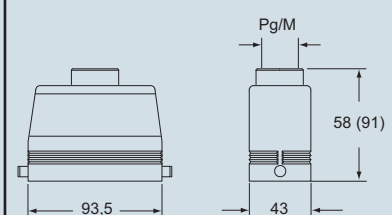

CAF/CFF and MAF/MFF

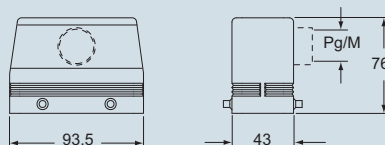

CALUS Type 4/4X/12



according to the type of lever

dimensions shown are not binding and may be changed without notice

inserts:		page
CD	40 poles + ⊕	49
CDD	72 poles + ⊕	62
CQE	32 poles + ⊕	82
CSH	16 poles + ⊕	90
CCE	16 poles + ⊕	98
CNE, CSE, JCNE, JCSE	16 poles + ⊕	99 and 108
CSS	16 poles + ⊕	120
CMSE	6+2 (aux) poles + ⊕	137
CMCE	6+2 (aux) poles + ⊕	136
CP	6 poles + ⊕	149
CX	6/36 and 12/2 poles + ⊕	152+153
CX	4/0 and 4/2 poles + ⊕	154
MIXO	4 modules	156+195

insert centre distance: **77.5 x 27 mm**

hoods with double top entry



hoods with double front entry



description	part no.	entry Pg	part no.	entry M	part no.	entry Pg	part no.	entry M
with pegs for two levers - used with enclosures size "77.27" - used with enclosures size "77.27"	CAV 16.216	16 x 2	MAV 16.220	20 x 2				
	CAV 16.221	21 x 2	MAV 16.225	25 x 2				
with pegs for 2 lever, without adaptor * - used with enclosures size "77.27" - used with enclosures size "77.27"	CFV 16.216	16 x 2	MFV 16.220	20 x 2				
	CFV 16.221	21 x 2	MFV 16.225	25 x 2				
with pegs for two levers - used with enclosures size "77.27"					CAF 16.221	21 x 2	MAF 16.225	25 x 2
with pegs for 2 lever, without adaptor * - used with enclosures size "77.27"					CFF 16.221	21 x 2	MFF 16.225	25 x 2

* enclosure without adaptor, threaded on the body, to be used only with a complete cable gland.

dimensions in mm
CAV/CFV and MAV/MFV

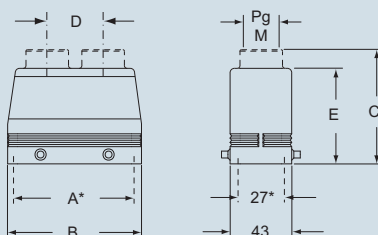

dimensions in mm
CAF/CFF and MAF/MFF

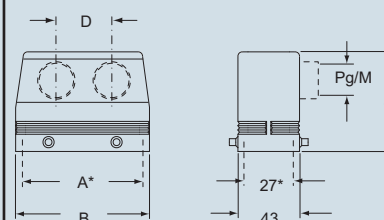

part	A*	B	C	D
CAF/CFF 16.221 / MAF/MFF 16.225	77.5	93.5	76	40

*) screw fixing centre distance

alternatively, hoods with pegs are coupled with fixed enclosures:
- C7, IP67 stainless steel lever, page 254
- CV, IP66 stainless steel lever, page 260
- JEI, IP66 galvanised steel lever, page 288

part	A*	B	C	D	E
CAV 16.216/MAV 16.220	77.5	93.5	89 (90.5)	35 (30)	76
CAV 16.221/MAV 16.225	77.5	93.5	90.5	40	76
CFV 16.216/MFV 16.220	77.5	93.5	—	30 (35)	76
CFV 16.221/MFV 16.225	77.5	93.5	—	40	76

*) screw fixing centre distance

CALUS Type
4/4X/12



dimensions shown are not binding
and may be changed without notice

inserts:		page
CD	40 poles + ⊕	49
CDD	72 poles + ⊕	62
CQE	32 poles + ⊕	82
CSH	16 poles + ⊕	90
CCE	16 poles + ⊕	98
CNE, CSE, JCNE, JCSE	16 poles + ⊕	99 and 108
CSS	16 poles + ⊕	120
CMSE	6+2 (aux) poles + ⊕	137
CMCE	6+2 (aux) poles + ⊕	136
CP	6 poles + ⊕	149
CX	6/36 and 12/2 poles + ⊕	152 and 153
CX	4/0 and 4/2 poles + ⊕	154
MIXO	4 modules	156+195

insert centre distance:
77.5 x 27 mm

inclined hoods for 2 levers with side entry



NEW

inclined hoods for 2 levers with top entry



NEW

description	part no.	entry Pg	part no.	entry M	part no.	entry Pg	part no.	entry M
used with enclosures size "77.27"								
- with pegs for two levers, side entry								
- with pegs for two levers, side entry	CIO 16.36	36	MIO 16.40	40				
			MIO 16.50	50				
used with enclosures size "77.27"								
- with pegs for two levers, top entry					CIV 16.29	29	MIV 16.40	40

alternatively, hoods with pegs
are coupled with fixed enclosures:
- C7, IP67 stainless steel lever, page 254
- CV, IP66 stainless steel lever, page 260
- JEI, IP66 galvanised steel lever, page 288

dimensions in mm

CIO and MIO

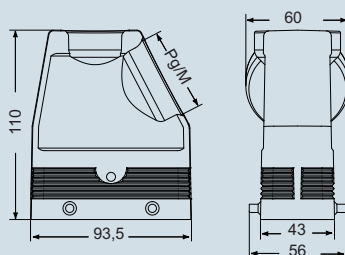

dimensions in mm

CIV and MIV

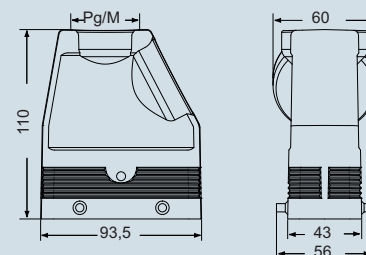

according to the type of lever

dimensions shown are not binding
and may be changed without notice

inserts:		page
CD	40 poles + ⊕	49
CDD	72 poles + ⊕	62
CQE	32 poles + ⊕	82
CSH	16 poles + ⊕	90
CCE	16 poles + ⊕	98
CNE, CSE, JCNE, JCSE	16 poles + ⊕	99 and 108
CSS	16 poles + ⊕	120
CMSE	6+2 (aux) poles + ⊕	137
CMCE	6+2 (aux) poles + ⊕	136
CP	6 poles + ⊕	149
CX	6/36 and 12/2 poles + ⊕	152+153
CX	4/0 and 4/2 poles + ⊕	154
MIXO	4 modules	156+195

insert centre distance: **77.5 x 27 mm**

hoods with 2 levers



hoods with 1 lever



description	part no.	entry Pg	part no.	entry M	part no.	entry Pg	part no.	entry M
with levers and gasket, top entry	CHV 16 G	21	MHV 16 G32	32	CHV 16 LG	21	MHV 16 LG32	32
with levers and gasket, top entry, high construction	CAV 16 G	21	MAV 16 G25	25	CAV 16 LG21	21	MAV 16 LG25	25
with levers and gasket, top entry, high construction	CAV 16 G29	29	MAV 16 G32	32	CAV 16 LG29	29	MAV 16 LG32	32
with levers and gasket, top entry, high, without adaptor *	CFV 16 G	21	MFV 16 G25	25	CFV 16 LG21	21	MFV 16 LG25	25
with levers and gasket, top entry, high, without adaptor *	CFV 16 G29	29	MFV 16 G32	32	CFV 16 LG29	29	MFV 16 LG32	32

* enclosure without adaptor, threaded on the body, to be used only with a complete cable gland.

dimensions in mm

**CHV G (CAV G) and [CFV G],
MHV G (MAV G) and [MFV G]**

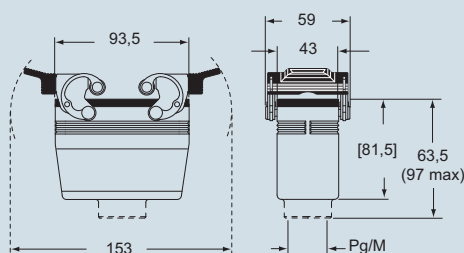

dimensions in mm

**CHV LG (CAV LG) and [CFV LG],
MHV LG (MAV LG) and [MFV LG]**

CALUS® Type
4/4X/12

dimensions shown are not binding
and may be changed without notice

C-TYPE - size 77.27

233

inserts:		page
CD	40 poles + ⊕	49
CDD	72 poles + ⊕	62
CQE	32 poles + ⊕	82
CSH	16 poles + ⊕	90
CCE	16 poles + ⊕	98
CNE, CSE, JCNE, JCSE	16 poles + ⊕	99 and 108
CSS	16 poles + ⊕	120
CMSE	6+2 (aux) poles + ⊕	137
CMCE	6+2 (aux) poles + ⊕	136
CP	6 poles + ⊕	149
CX	6/36 and 12/2 poles + ⊕	152+153
CX	4/0 and 4/2 poles + ⊕	154
MIXO	4 modules	156+195

insert centre distance:
77.5 x 27 mm

hoods with 2 levers

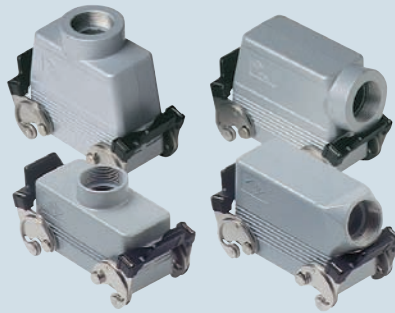

covers

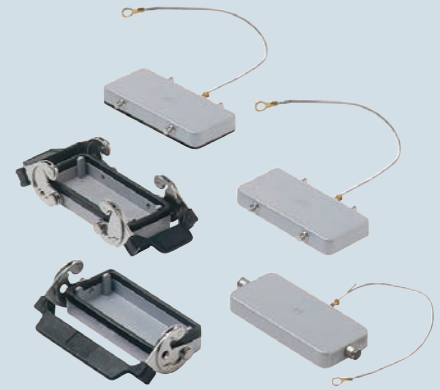

description	part no.	entry Pg	part no.	entry M	part no.
with levers, side entry ¹⁾	CHO 16 X	21	MHO 16 X25	25	
with levers, side entry ¹⁾			MHO 16 X32	32	
with levers, side entry, high construction ¹⁾	CAO 16 X	21	MAO 16 X32	32	
with levers, side entry, high construction ¹⁾	CAO 16 X29	29	MAO 16 X40	40	
with levers, top entry ¹⁾	CHV 16 X	21	MHV 16 X25	25	
with levers, top entry ¹⁾			MHV 16 X32	32	
with levers, top entry, high construction ¹⁾	CAV 16 X	21	MAV 16 X32	32	
with levers, top entry, high construction ¹⁾	CAV 16 X29	29	MAV 16 X40	40	
with 4 pegs (for enclosures with 2 levers with gasket)					CHC 16
with 4 pegs and gasket (for enclosures with 2 levers) ²⁾					CHC 16 C
with 2 pegs (for enclosures with 1 lever with gasket)					CHC 16 L
with 2 levers (for hoods with 4 pegs)					CHC 16 G
with 1 lever (for hoods with 2 pegs)					CHC 16 LG

¹⁾ may be combined with enclosures:
- CHI/CHP/CAP 16 CS/CP/C
- MHP/MAP 16 CS/CP

²⁾ may be combined with enclosures:
- CHO/CAO 16 X and CHV/CAV 16 X
- MHO/MAO 16 X and MHV/MAV 16 X

dimensions in mm

CHO X (CAO X) and MHO X (MAO X)

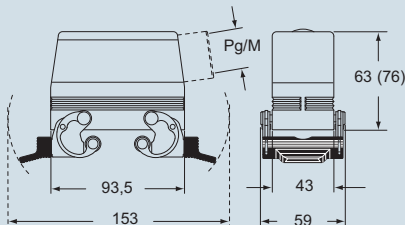

CHV X (CAV X) and MHV X (MAV X)

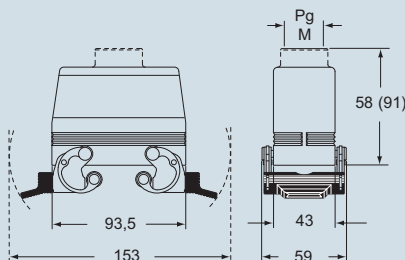

dimensions in mm

CHC

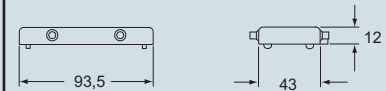

CHC C



CHC L



CHC G

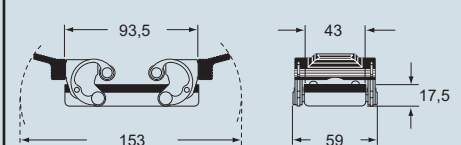

CHC LG

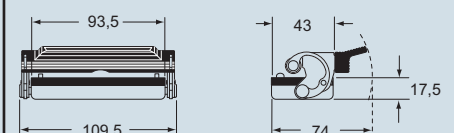

CALUS Type
4/4X/12



dimensions shown are not binding
and may be changed without notice



inserts:		page
CD	64 . poles + ⊕	51
CT, CTS (10A)	64 . poles + ⊕	57
CDD	108 . poles + ⊕	64
CQE	46 . poles + ⊕	83
CSH	24 . poles + ⊕	91
CCE	24 . poles + ⊕	100
CNE, CSE, JCNE, JCSE	24 . poles + ⊕ 101 and 109	
CSS	24 . poles + ⊕	121
CT, CTE, CTSE (16A)	24 poles + ⊕ 129 and 133	
CMSE	10+2 (aux) . poles + ⊕	139
CMCE	10+2 (aux) . poles + ⊕	138
CX	4/8 . poles + ⊕	155
MIXO	6 . modules	156+195

insert centre distance:
104 x 27 mm

bulkhead mounting housings with 2 levers or 4 pegs



bulkhead mounting housings with single lever



description	part no.	part no.
with one or two levers	CHI 24	CHI 24 L
with pegs ¹⁾	CHI 24 C	
with pegs and aluminum cover ¹⁾	CHI 24 CS	
with pegs and plastic cover ¹⁾	CHI 24 CP	
with lever and cover		CHI 24 LS

¹⁾ may be combined with enclosures:
- CHO/CAO 24 X and CHV/CAV 24 X
- MHO/MAO 24 X and MHV/MAV 24 X

NB: the enclosures ensure IP66 protection (or IP65 for cover versions) rating when mated and locked with the closing levers.
The door (CS, CP) only ensures mechanical protection, but does not ensure IP65 protection rating.

panel cut-out for bulkhead mounting housings in mm

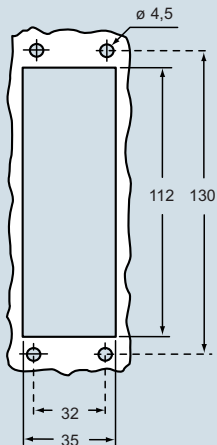

dimensions in mm

CHI

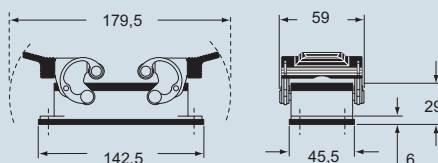

CHI C

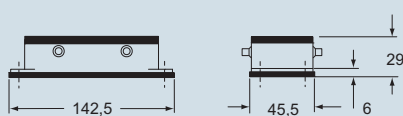

CHI CS/CP

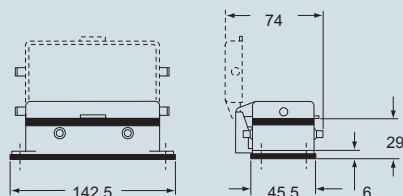

dimensions in mm

CHI L

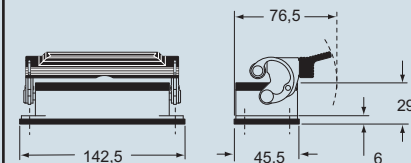

CHI LS

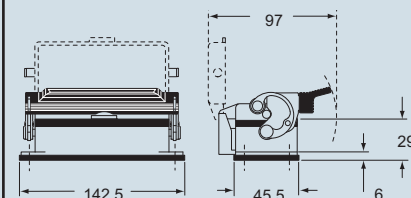

CAVUS® Type
4/4X/12

(excluding enclosures with plastic cover)



dimensions shown are not binding
and may be changed without notice

inserts:		page
CD	64 poles + ⊕	51
CDD	108 poles + ⊕	64
CQE	46 poles + ⊕	83
CSH	24 poles + ⊕	91
CCE	24 poles + ⊕	100
CNE, CSE, JCNE, JCSE	24 poles + ⊕ 101 and 109	
CSS	24 poles + ⊕	121
CMSE	10+2 (aux) poles + ⊕	139
CMCE	10+2 (aux) poles + ⊕	138
CX	4/8 poles + ⊕	155
MIXO	6 modules	156+195

insert centre distance:
104 x 27 mm

surface mounting housings with 2 levers or 4 pegs



surface mounting housings with single lever

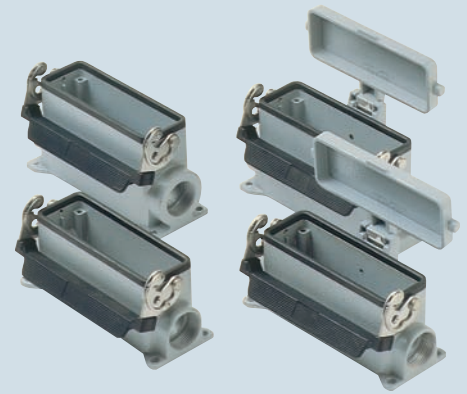

description	part no.	entry Pg	part no.	entry M	part no.	entry Pg	part no.	entry M
with levers	CHP 24	21	MHP 24.25	25	CHP 24 L	21	MHP 24 L25	25
with levers	CHP 24.2	21 x 2	MHP 24.225	25 x 2	CHP 24 L2	21 x 2	MHP 24 L225	25 x 2
with levers, high	CAP 2421	21	MAP 2432	32	CAP 24 L	21	MAP 24 L32	32
with levers, high	CAP 24.221	21 x 2	MAP 24.232	32 x 2	CAP 24 L2	21 x 2	MAP 24 L232	32 x 2
with levers, high	CAP 2429	29	MAP 2440	40	CAP 24 L29	29	MAP 24 L40	40
with levers, high	CAP 24.229	29 x 2	MAP 24.240	40 x 2	CAP 24 L229	29 x 2	MAP 24 L240	40 x 2
with pegs and aluminum cover ¹⁾	CHP 24 CS	21	MHP 24 CS25	25				
with pegs and aluminum cover ¹⁾	CHP 24 CS2	21 x 2	MHP 24 CS225	25 x 2				
with pegs and aluminum cover, high ¹⁾	CAP 24 CS	21	MAP 24 CS32	32				
with pegs and aluminum cover, high ¹⁾	CAP 24 CS2	21 x 2	MAP 24 CS232	32 x 2				
with pegs and aluminum cover, high ¹⁾	CAP 24 CS29	29	MAP 24 CS40	40				
with pegs and aluminum cover, high ¹⁾	CAP 24 CS229	29 x 2	MAP 24 CS240	40 x 2				
with pegs and plastic cover ¹⁾	CHP 24 CP	21	MHP 24 CP25	25				
with pegs and plastic cover ¹⁾	CHP 24 CP2	21 x 2	MHP 24 CP225	25 x 2				
with pegs and plastic cover, high ¹⁾	CAP 24 CP	21	MAP 24 CP32	32				
with pegs and plastic cover, high ¹⁾	CAP 24 CP2	21 x 2	MAP 24 CP232	32 x 2				
with pegs and plastic cover, high ¹⁾	CAP 24 CP29	29	MAP 24 CP40	40				
with pegs and plastic cover, high ¹⁾	CAP 24 CP229	29 x 2	MAP 24 CP240	40 x 2				
with lever and cover					CHP 24 LS	21	MHP 24 LS25	25
with lever and cover					CHP 24 LS2	21 x 2	MHP 24 LS225	25 x 2
with lever and cover, high					CAP 24 LS	21	MAP 24 LS32	32
with lever and cover, high					CAP 24 LS2	21 x 2	MAP 24 LS232	32 x 2
with lever and cover, high					CAP 24 LS29	29	MAP 24 LS40	40
with lever and cover, high					CAP 24 LS229	29 x 2	MAP 24 LS240	40 x 2

¹⁾ may be combined with enclosures:
- CHO/CAO 24 X and CHV/CAV 24 X
- MHO/MAO 24 X and MHV/MAV 24 X

NB: the enclosures ensure IP66 protection (or IP65 for cover versions) rating when mated and locked with the closing levers.
The cover (CS, CP) only ensures mechanical protection, but does not ensure IP65 protection rating.

dimensions in mm

CHP - CAP and MHP - MAP

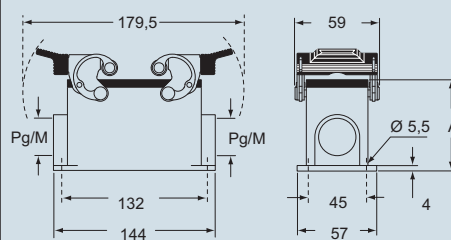

CHP CS/CP - CAP CS/CP and MHP CS/CP - MAP CS/CP

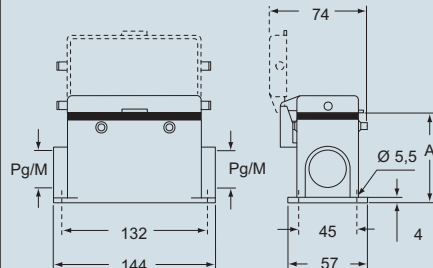

type	A
CHP / MHP	63
CAP / MAP	81
CHP CS / MHP CS	63
CAP CS / MAP CS	81
CHP CP / MHP CP	63
CAP CP / MAP CP	81

dimensions in mm

CHP L - CAP L and MHP L - MAP L

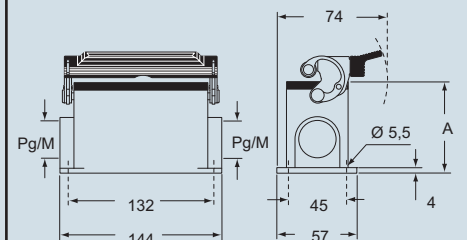

CHP LS - CAP LS and MHP LS - MAP LS

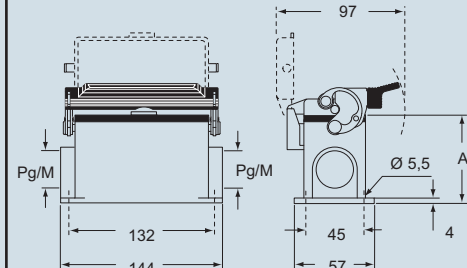

type	A
CHP L / MHP L	63
CAP L / MAP L	81
CHP LS / MHP LS	63
CAP LS / MAP LS	81

CAVUS Type 4/4X/12

(excluding enclosures with plastic cover)



dimensions shown are not binding
and may be changed without notice

inserts:		page
CD	64 poles + ⊕	51
CDD	108 poles + ⊕	64
CQE	46 poles + ⊕	83
CSH	24 poles + ⊕	91
CCE	24 poles + ⊕	100
CNE, CSE, JCNE, JCSE	24 poles + ⊕	101 and 109
CSS	24 poles + ⊕	121
CMSE	10+2 (aux) poles + ⊕	139
CMCE	10+2 (aux) poles + ⊕	138
CX	4/8 poles + ⊕	155
MIXO	6 modules	156÷195

insert centre distance:
104 x 27 mm

hoods with 4 pegs



hoods with 2 pegs

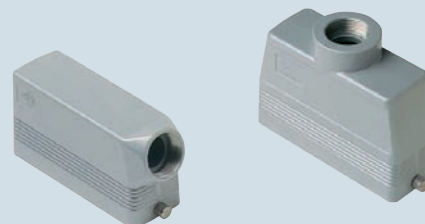

description	part no.	entry Pg	part no.	entry M	part no.	entry Pg	part no.	entry M
with pegs, side entry	CHO 24	21	MHO 24.25	25	CHO 24 L	21	MHO 24 L25	25
with pegs, side entry			MHO 24.32	32			MHO 24 L32	32
with pegs, side entry, high	CAO 24.21	21	MAO 24.32	32	CAO 24 L21	21	MAO 24 L32	32
with pegs, side entry, high	CAO 24.29	29	MAO 24.40	40	CAO 24 L29	29	MAO 24 L40	40
with pegs, top entry	CHV 24	21	MHV 24.25 **	25	CHV 24 L	21	MHV 24 L25	25
with pegs, top entry			MHV 24.32	32			MHV 24 L32	32
with pegs, top entry	CHV 24.29	29	MHV 24.40	40	CHV 24 L29	29	MHV 24 L40	40
with pegs, top entry, high	CAV 24.21	21	MAV 24.32	32	CAV 24 L21	21	MAV 24 L32	32
with pegs, top entry, high	CAV 24.29	29	MAV 24.40	40	CAV 24 L29	29	MAV 24 L40	40
with pegs, frontal entry, high construction	CAF 24.21	21	MAF 24.25	25				
with pegs, frontal entry, high construction	CAF 24.29	29	MAF 24.32	32				
with pegs, frontal entry, high constr., without adaptor *	CFF 24.21	21	MFF 24.25	25				
with pegs, frontal entry, high constr., without adaptor *	CFF 24.29	29	MFF 24.32	32				

* enclosure without adaptor, threaded on the body, to be used only with a complete cable gland.

** can only be used with a complete cable gland (to be purchased separately)

dimensions in mm

CHO (CAO) and MHO (MAO)

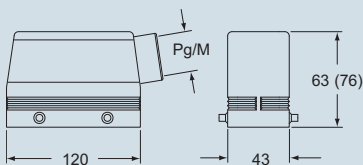

dimensions in mm

CHO L (CAO L) and MHO L (MAO L)

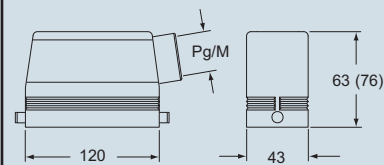

alternatively, hoods with pegs are coupled with fixed enclosures:
- C7, IP67 stainless steel lever, page 254
- CV, IP66 stainless steel lever, page 260
- JEI, IP66 galvanised steel lever, page 288

CHV (CAV) and MHV (MAV)

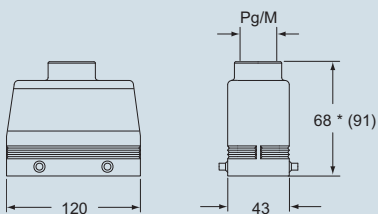

* 69.5 for Pg 29 - M 40 versions

CHV L (CAV L) and MHV L (MAV L)

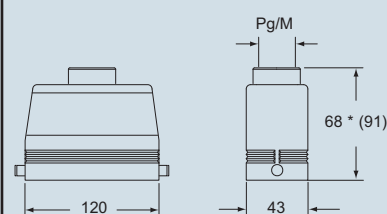

* 69.5 for Pg 29 - M 40 versions

CAF/CFF and MAF/MFF

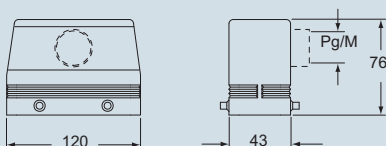

CALUS Type 4/4X/12



according to the type of lever

dimensions shown are not binding
and may be changed without notice

inserts:		page
CD	64 poles + ⊕	51
CDD	108 poles + ⊕	64
CQE	46 poles + ⊕	83
CSH	24 poles + ⊕	91
CCE	24 poles + ⊕	100
CNE, CSE, JCNE, JCSE	24 poles + ⊕	101 and 109
CSS	24 poles + ⊕	121
CMSE	10+2 (aux) poles + ⊕	139
CMCE	10+2 (aux) poles + ⊕	138
CX	4/8 poles + ⊕	155
MIXO	6 modules	156+195

insert centre distance:
104 x 27 mm

hoods with double top entry and 4 pegs



hoods with double front entry and 4 pegs



description	part no.	entry Pg	part no.	entry M	part no.	entry Pg	part no.	entry M
with pegs for two levers - used with enclosures size "104.27" - used with enclosures size "104.27"	CAV 24.221 CAV 24.229	21 x 2 29 x 2	MAV 24.232	32 x 2				
with pegs for 2 lever, without adaptor * - used with enclosures size "104.27"	CFV 24.221	21 x 2	MFV 24.232	32 x 2				
with pegs for two levers - used with enclosures size "104.27"					CAF 24.221	21 x 2	MAF 24.225	25 x 2
with pegs for 2 lever, without adaptor * - used with enclosures size "104.27"					CFF 24.221	21 x 2	MFF 24.225	25 x 2

* enclosure without adaptor, threaded on the body, to be used only with a complete cable gland.

dimensions in mm
CAV/CFV and MAV/MFV

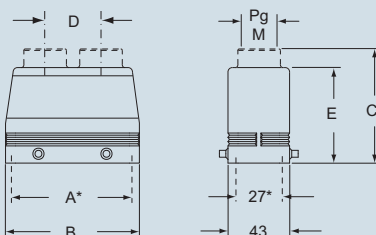

part	A*	B	C	D	E
CAV 24.221/MAV 24.232	104	120	90.5 (91)	50	76
CAV 24.229	104	120	90.5	50	76
CFV 24.221/MFV 24.232	104	120	—	50	76

*) screw fixing centre distance

dimensions in mm
CAF/CFF and MAF/MFF

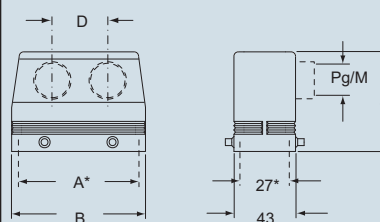

part	A*	B	C	D
CAF/CFF 24.221 / MAF/MFF 24.225	104	120	76	50

*) screw fixing centre distance

alternatively, hoods with pegs are coupled with fixed enclosures:
- C7, IP67 stainless steel lever, page 254
- CV, IP66 stainless steel lever, page 260
- JEI, IP66 galvanised steel lever, page 288

CALUS Type
4/4X/12



dimensions shown are not binding
and may be changed without notice

inserts:		page
CD	64 poles + ⊕	51
CDD	108 poles + ⊕	64
CQE	46 poles + ⊕	83
CSH	24 poles + ⊕	91
CCE	24 poles + ⊕	100
CNE, CSE, JCNE, JCSE	24 poles + ⊕	101 and 109
CSS	24 poles + ⊕	121
CMSE	10+2 (aux) poles + ⊕	139
CMCE	10+2 (aux) poles + ⊕	138
CX	4/8 poles + ⊕	155
MIXO	6 modules	156+195

insert centre distance:
104 x 27 mm

**inclined hoods for 2 levers
with side entry**



NEW

**inclined hoods for 2 levers
with top entry**

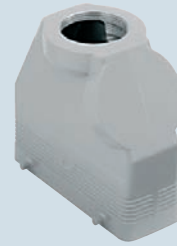

NEW

description	part no.	entry Pg	part no.	entry M	part no.	entry Pg	part no.	entry M
used with enclosures size "104.27" - with pegs for two levers, side entry - with pegs for two levers, side entry	CIO 24.36	36	MIO 24.40 MIO 24.50	40 50				
used with enclosures size "104.27" - with pegs for two levers, top entry - with pegs for two levers, top entry					CIV 24.36	36	MIV 24.40 MIV 24.50	40 50

dimensions in mm

CIO and MIO

alternatively, hoods with pegs
are coupled with fixed enclosures:
- C7, IP67 stainless steel lever, page 254
- CV, IP66 stainless steel lever, page 260
- JEI, IP66 galvanised steel lever, page 288

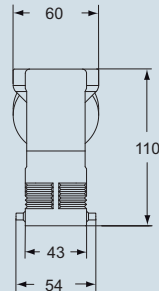
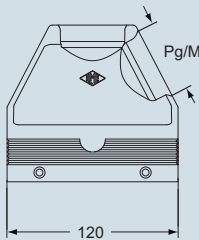

dimensions in mm

CIV and MIV

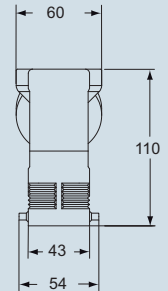
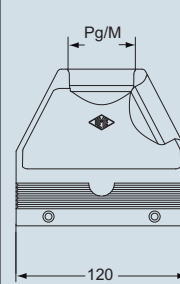

according to the type of lever

dimensions shown are not binding
and may be changed without notice



inserts:		page
CD	64 poles + ⊕	51
CDD	108 poles + ⊕	64
CQE	46 poles + ⊕	83
CSH	24 poles + ⊕	91
CCE	24 poles + ⊕	100
CNE, CSE, JCNE, JCSE	24 poles + ⊕	101 and 109
CSS	24 poles + ⊕	121
CMSE	10+2 (aux) poles + ⊕	139
CMCE	10+2 (aux) poles + ⊕	138
CX	4/8 poles + ⊕	155
MIXO	6 modules	156+195

insert centre distance:
104 x 27 mm

enlarged hoods,
side or top entry with 4 pegs

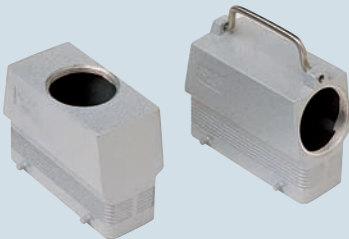

description	part no.	entry Pg	part no.	entry M
used with enclosures size "104.27"				
- with pegs for two levers, side entry	CQO 24	36	MQO 24.40	40
- with pegs for two levers, top entry	CQV 24	36	MQV 24.40	40

alternatively, hoods with pegs
are coupled with fixed enclosures:
- C7, IP67 stainless steel lever, page 254
- CV, IP66 stainless steel lever, page 260
- JEI, IP66 galvanised steel lever, page 288

dimensions in mm

CQO and MQO

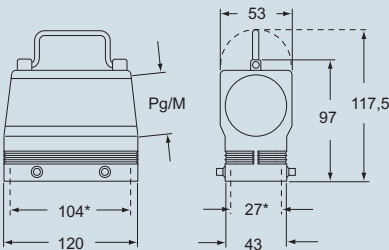

CQV and MQV

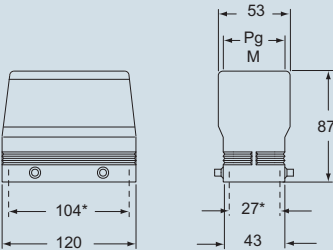

*) screw fixing centre distance

CALUS Type
4/4X/12



according to the type of lever

dimensions shown are not binding
and may be changed without notice

inserts:		page
CD	64 poles + ⊕	51
CDD	108 poles + ⊕	64
CQE	46 poles + ⊕	83
CSH	24 poles + ⊕	91
CCE	24 poles + ⊕	100
CNE, CSE, JCNE, JCSE	24 poles + ⊕	101 and 109
CSS	24 poles + ⊕	121
CMSE	10+2 (aux) poles + ⊕	139
CMCE	10+2 (aux) poles + ⊕	138
CX	4/8 poles + ⊕	155
MIXO	6 modules	156÷195

insert centre distance:
104 x 27 mm

hoods with 2 levers



hoods with 1 lever



description	part no.	entry Pg	part no.	entry M	part no.	entry Pg	part no.	entry M
with levers and gasket, top entry	CHV 24 G	21	MHV 24 G32	32	CHV 24 LG	21	MHV 24 LG32	32
with levers and gasket, top entry, high construction	CAV 24 G	21	MAV 24 G25	25	CAV 24 LG21	21	MAV 24 LG25	25
with levers and gasket, top entry, high construction	CAV 24 G29	29	MAV 24 G32	32	CAV 24 LG29	29	MAV 24 LG32	32
with levers and gasket, top entry, high, without adapter *	CFV 24 G	21	MFV 24 G25	25	CFV 24 LG21	21	MFV 24 LG25	25
with levers and gasket, top entry, high, without adapter *	CFV 24 G29	29	MFV 24 G32	32	CFV 24 LG29	29	MFV 24 LG32	32

* enclosure without adaptor, threaded on the body, to be used only with a complete cable gland.

dimensions in mm

CHV G (CAV G) and [CFV G],
MHV G (MAV G) and [MFV G]

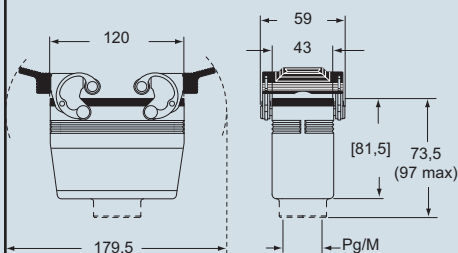

dimensions in mm

CHV LG (CAV LG) and [CFV LG],
MHV LG (MAV LG) and [MFV LG]

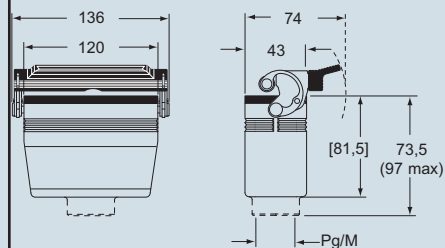

CALUS Type
4/4X/12



dimensions shown are not binding
and may be changed without notice

inserts:		page
CD	64 poles + ⊕	51
CDD	108 poles + ⊕	64
CQE	46 poles + ⊕	83
CSH	24 poles + ⊕	91
CCE	24 poles + ⊕	100
CNE, CSE, JCNE, JCSE	24 poles + ⊕	101 and 109
CSS	24 poles + ⊕	121
CMSE	10+2 (aux) poles + ⊕	139
CMCE	10+2 (aux) poles + ⊕	138
CX	4/8 poles + ⊕	155
MIXO	6 modules	156+195

insert centre distance: **104 x 27 mm**

hoods with 4 pegs

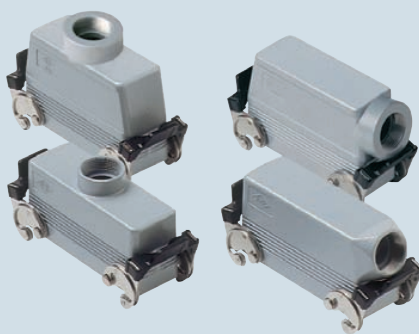

covers

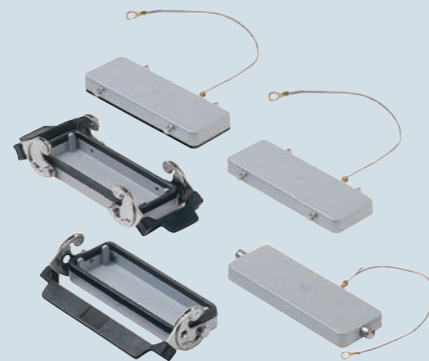

description	part no.	entry Pg	part no.	entry M	part no.
with levers, side entry ¹⁾	CHO 24 X	21	MHO 24 X25	25	
with levers, side entry ¹⁾			MHO 24 X32	32	
with levers, side entry, high ¹⁾	CAO 24 X	21	MAO 24 X32	32	
with levers, side entry, high ¹⁾	CAO 24 X29	29	MAO 24 X40	40	
with levers, top entry ¹⁾	CHV 24 X	21	MHV 24 X25	25	
with levers, top entry ¹⁾			MHV 24 X32	32	
with levers, top entry, high ¹⁾	CAV 24 X	21	MAV 24 X32	32	
with levers, top entry, high ¹⁾	CAV 24 X29	29	MAV 24 X40	40	
with 4 pegs (for enclosures with 2 levers with gasket)					CHC 24
with 4 pegs and gasket (for enclosures with 2 levers) ²⁾					CHC 24 C
with 2 pegs (for enclosures with 1 lever with gasket)					CHC 24 L
with 2 levers (for hoods with 4 pegs)					CHC 24 G
with 1 lever (for hoods with 2 pegs)					CHC 24 LG

¹⁾ may be combined with enclosures:

- CHI/CHP/CAP 24 CS/CP/C
- MHP/MAP 24 CS/CP

²⁾ may be combined with enclosures:

- CHO/CAO 24 X and CHV/CAV 24 X
- MHO/MAO 24 X and MHV/MAV 24 X

dimensions in mm

CHO X (CAO X) and MHO X (MAO X)

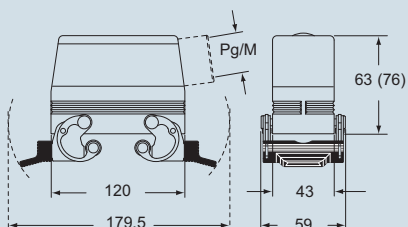

CHV X (CAV X) and MHV X (MAV X)

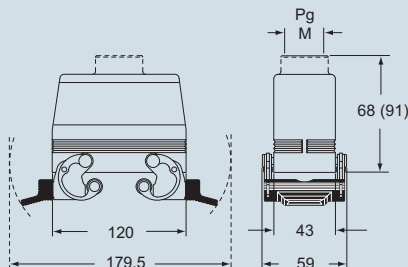

dimensions in mm

CHC



CHC C



CHC L

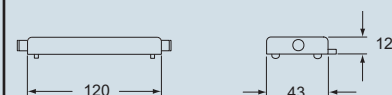

CHC G

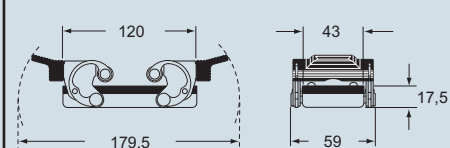

CHC LG

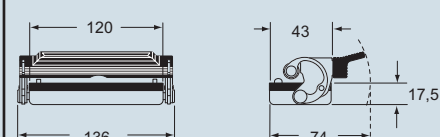

CAI[®] US Type
4/4X/12



dimensions shown are not binding
and may be changed without notice

inserts:		page
CD	80 poles + ⊕	52
CDD	144 poles + ⊕	65
CQE	64 poles + ⊕	84
CSH	32 poles + ⊕	92
CCE	32 poles + ⊕	102
CNE, CSE, JCNE, JCSE	32 poles + ⊕	103 and 110
CSS	32 poles + ⊕	122
CMSE	12+4 (aux) poles + ⊕	141
CMCE	12+4 (aux) poles + ⊕	140
CME	12+4 (aux) poles + ⊕	141
CP	12 poles + ⊕	150
MIXO	4 + 4 modules	156÷195

insert centre distance:
2 x (77.5 x 27) mm

bulkhead mounting housings with 2 levers or 4 pegs



bulkhead mounting housings with single lever



description	part no.	part no.
with one or two levers	CHI 32	CHI 32 L
with pegs and cover ¹⁾	CHI 32 CS	
with lever and cover		CHI 32 LS

¹⁾ may be combined with enclosures:
- CHO/CHV/CFV/CFV 32 X
- MHO/MHV/MFO/MFV 32 X

NB: the enclosures ensure IP66 protection (or IP65 for cover versions) rating when mated and locked with the closing levers.
The cover (CS) only ensures mechanical protection, but does not ensure IP65 protection rating.

panel cut-out for bulkhead mounting housings in mm

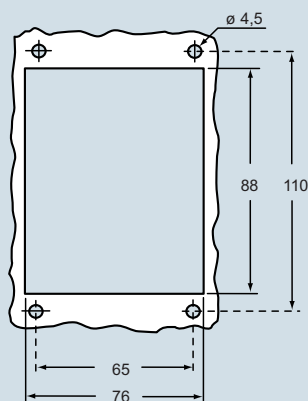

dimensions in mm

CHI

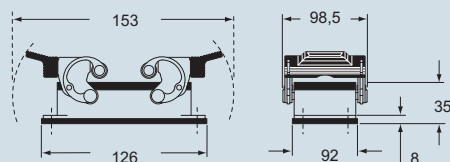

CHI CS

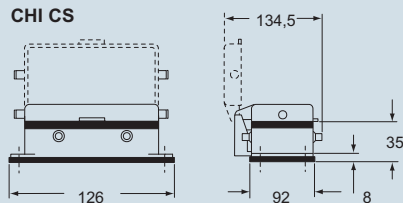

dimensions in mm

CHI L

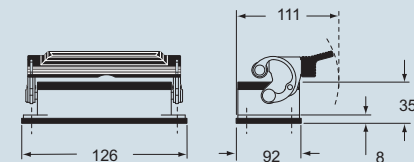

CHI LS

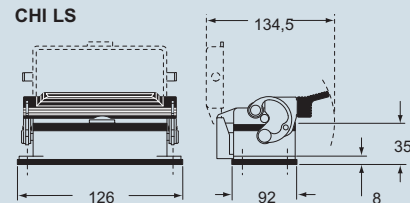

CALUS Type
4/4X/12



dimensions shown are not binding
and may be changed without notice

inserts:		page
CD	80 poles + ⊕	52
CDD	144 poles + ⊕	65
CQE	64 poles + ⊕	84
CSH	32 poles + ⊕	92
CCE	32 poles + ⊕	102
CNE, CSE, JCNE, JCSE	32 poles + ⊕	103 and 110
CSS	32 poles + ⊕	122
CMSE	12+4 (aux) poles + ⊕	141
CMCE	12+4 (aux) poles + ⊕	140
CME	12+4 (aux) poles + ⊕	141
CP	12 poles + ⊕	150
MIXO	4 + 4 modules	156÷195

insert centre distance:
2 x (77.5 x 27) mm

surface mounting housing with 2 levers



surface mounting housings with single lever



description	part no.	entry Pg	part no.	entry M	part no.	entry Pg	part no.	entry M
with one or two levers	CHP 32.29	29	MHP 3240	40	CHP 32 L29	29	MHP 32 L40	40
with one or two levers	CHP 32,229	29 x 2	MHP 32.240	40 x 2	CHP 32 L229	29 x 2	MHP 32 L240	40 x 2
with one or two levers	CHP 32	36	MHP 3250	50	CHP 32 L	36	MHP 32 L50	50
with one or two levers	CHP 32.2	36 x 2	MHP 32.250	50 x 2	CHP 32 L2	36 x 2	MHP 32 LS250	50 x 2
with one or two levers	CHP 32.42	42			CHP 32 L42	42		
with one or two levers	CHP 32,242	42 x 2			CHP 32 L242	42 x 2		
with lever and cover					CHP 32 LS29	29	MHP 32 LS40	40
with lever and cover					CHP 32 LS229	29 x 2	MHP 32 LS240	40 x 2
with lever and cover					CHP 32 LS	36	MHP 32 LS50	50
with lever and cover					CHP 32 LS2	36 x 2	MHP 32 LS250	50 x 2
with lever and cover					CHP 32 LS42	42		
with lever and cover					CHP 32 LS242	42 x 2		

NB: the enclosures ensure IP66 protection (or IP65 for cover versions) rating when mated and locked with the closing levers.

The cover (CS) only ensures mechanical protection, but does not ensure IP65 protection rating.

dimensions in mm

CHP and MHP

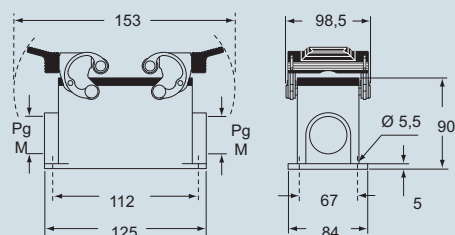

dimensions in mm

CHP L and MHP L

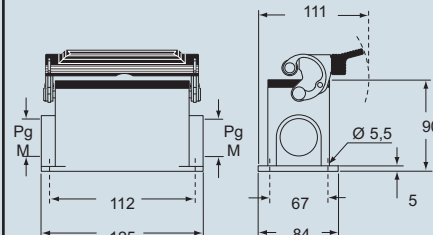

CHP LS and MHP LS

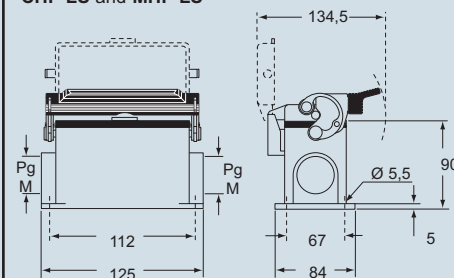

CALUS® Type
4/4X/12



dimensions shown are not binding
and may be changed without notice

inserts:		page
CD	80 poles + ⊕	52
CDD	144 poles + ⊕	65
CQE	64 poles + ⊕	84
CSH	32 poles + ⊕	92
CCE	32 poles + ⊕	102
CNE, CSE, JCNE, JCSE ..	32 poles + ⊕ 103 and 110	
CSS	32 poles + ⊕	122
CMSE	12+4 (aux) poles + ⊕	141
CMCE	12+4 (aux) poles + ⊕	140
CME	12+4 (aux) poles + ⊕	141
CP	12 poles + ⊕	150
MIXO	4 + 4 modules	156+195

insert centre distance:
2 x (77.5 x 27) mm

hoods with 4 pegs and 2 levers



hoods with 2 pegs and 1 lever



description	part no.	entry Pg	part no.	entry M	part no.	entry Pg	part no.	entry M
with pegs, side entry	CHO 32.29	29	MHO 32.32	32	CHO 32 L	36	MHO 32 L40	40
with pegs, side entry	CHO 32	36	MHO 32.40	40				
with pegs, side entry	CHO 32.42	42	MHO 32.50	50				
with pegs, side entry, without adaptor *	CFO 32.29	29	MFO 32.32	32	CFO 32 L	36	MFO 32 L40	40
with pegs, side entry, without adaptor *	CFO 32	36	MFO 32.40	40				
with pegs, side entry, without adaptor *	CFO 32.42	42	MFO 32.50	50				
with pegs, top entry	CHV 32.29	29	MHV 32.32	32	CHV 32 L	36	MHV 32 L40	40
with pegs, top entry	CHV 32	36	MHV 32.40	40				
with pegs, top entry	CHV 32.42	42	MHV 32.50	50				
with pegs, top entry, without adaptor *	CFV 32.29	29	MFV 32.32	32	CFV 32 L	36	MFV 32 L40	40
with pegs, top entry, without adaptor *	CFV 32	36	MFV 32.40	40				
with pegs, top entry, without adaptor *	CFV 32.42	42	MFV 32.50	50				
with levers and gasket, top entry	CHV 32 G29	29	MHV 32 G32	32	CHV 32 LG	36	MHV 32 LG40	40
with one or two levers and gasket, top entry	CHV 32 G	36	MHV 32 G40	40				
with levers and gasket, top entry	CHV 32 G42	42	MHV 32 G50	50				
with levers and gasket, top entry, without adaptor *	CFV 32 G29	29	MFV 32 G32	32	CFV 32 LG	36	MFV 32 LG40	40
with lever/s and gasket, top entry, without adaptor *	CFV 32 G	36	MFV 32 G40	40				
with levers and gasket, top entry, without adaptor *	CFV 32 G42	42	MFV 32 G50	50				

* enclosure without adaptor, threaded on the body, to be used only with a complete cable gland.

dimensions in mm

CHO/CFO and MHO/MFO

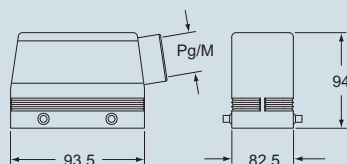

CHV/CFV and MHV/MFV

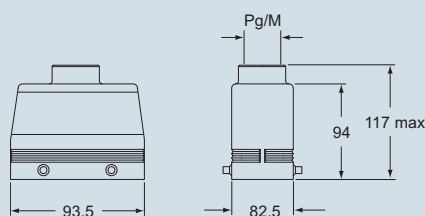

CHV/CFV G and MHV/MFV G

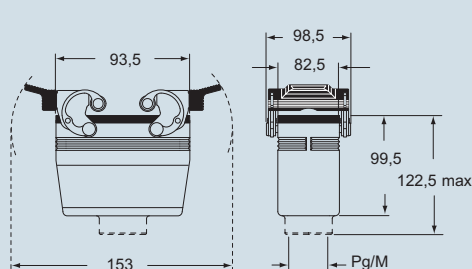

dimensions in mm

CHO/CFO L and MHO/MFO L

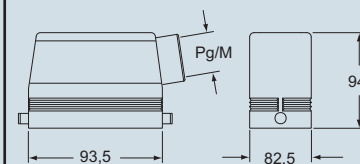

CHV/CFV L and MHV/MFV L

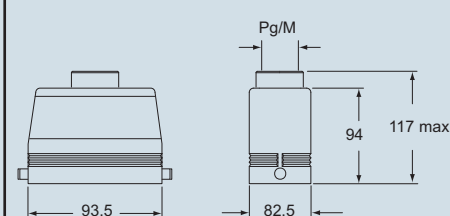

CHV/CFV LG and MHV/MFV LG

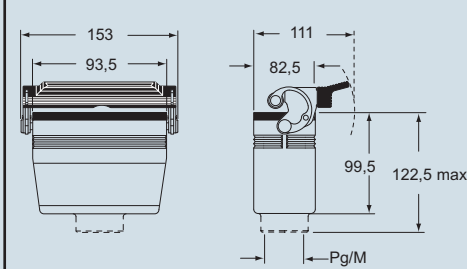

CAVUS Type
4/4X/12



dimensions shown are not binding
and may be changed without notice

inserts:		page
CD	80 poles + ⊕	52
CDD	144 poles + ⊕	65
CQE	64 poles + ⊕	84
CSH	32 poles + ⊕	92
CCE	32 poles + ⊕	102
CNE, CSE, JCNE, JCSE	32 poles + ⊕ 103 and 110	
CSS	32 poles + ⊕	122
CMSE	12+4 (aux) poles + ⊕	141
CMCE	12+4 (aux) poles + ⊕	140
CME	12+4 (aux) poles + ⊕	141
CP	12 poles + ⊕	150
MIXO	4 + 4 modules	156÷195

insert centre distance: 2 x (77.5 x 27) mm

Cover versions C, G and LG cannot be used together with coding pins. If this application is required, please contact ILME SpA.

hoods with 2 levers



covers

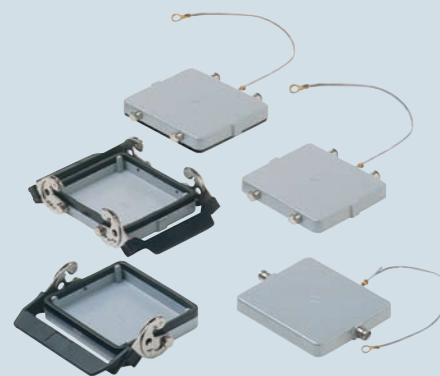

description	part no.	entry Pg	part no.	entry M	part no.
with levers, side entry ¹⁾	CHO 32 X	36	MHO 32 X40	40	
with levers, side entry, without adaptor * ¹⁾	CFO 32 X	36	MFO 32 X40	40	
with levers, top entry ¹⁾	CHV 32 X	36	MHV 32 X40	40	
with levers, top entry, without adaptor * ¹⁾	CFV 32 X	36	MFV 32 X40	40	
with 4 pegs (for enclosures with 2 levers with gasket) with 4 pegs and gasket (for enclosures with 2 levers) ²⁾ with 2 pegs (for enclosures with 1 lever with gasket)					CHC 32 CHC 32 C CHC 32 L
with 2 levers (for hoods with 4 pegs) with 1 lever (for hoods with 2 pegs)					CHC 32 G CHC 32 LG

* enclosure without adaptor, threaded on the body, to be used only with a complete cable gland.

¹⁾ may be combined with CHI 32 CS enclosures

²⁾ may be combined with enclosures:
- CHO/CFO 32 X and CHV/CFV 32 X
- MHO/MFO 32 X and MHV/MFV 32 X

dimensions in mm

CHO/CFO X and MHO/MFO X

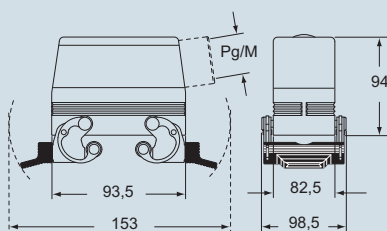

CHV/CFV X and MHV/MFV X

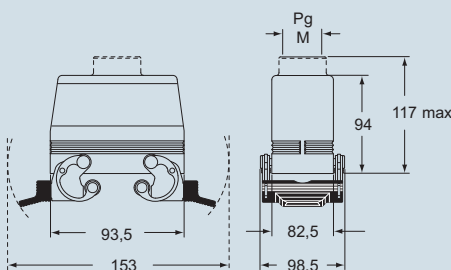

dimensions in mm

CHC

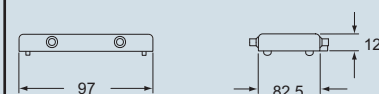

CHC C



CHC L

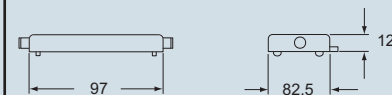

CHC G

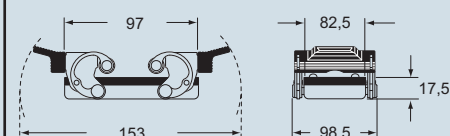

CHC LG

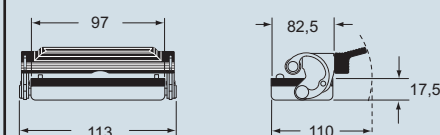

CALUS Type 4/4X/12



dimensions shown are not binding
and may be changed without notice

inserts:		page
CD	128 poles + ⊕	53
CDD	216 poles + ⊕	66
CQE	92 poles + ⊕	85
CSH	48 poles + ⊕	93
CCE	48 poles + ⊕	104
CNE, CSE, JCNE, JCSE	48 poles + ⊕ 105 and 111	
CSS	48 poles + ⊕	123
CMSE	20+4 (aux) poles + ⊕	143
CMCE	20+4 (aux) poles + ⊕	142
CME	20+4 (aux) poles + ⊕	143
CME	32+4 (aux) poles + ⊕	147
CMCE	32+4 (aux) poles + ⊕	146
MIXO	6 + 6 modules	156+195

insert centre distance:
2 x (104 x 27) mm

bulkhead and surface mounting enclosures with single lever



hoods with 2 pegs



description	part no.	entry Pg	part no.	entry M	part no.	entry Pg	part no.	entry M
bulkhead mounting enclosures with lever	CHI 48 L	—						
bulkhead mounting enclosures with lever and cover	CHI 48 LS	—						
surface mounting enclosures with lever and cover	CHP 48 LS29	29 x 2	MHP 48 LS40	40 x 2				
surface mounting enclosures with lever and cover	CHP 48 LS	36 x 2	MHP 48 LS50	50 x 2				
with pegs, side entry					CHO 48 L29	29	MHO 48 L32	32
with pegs, side entry					CHO 48 L	36	MHO 48 L40	40
with pegs, side entry					CHO 48 L42	42	MHO 48 L50	50
with pegs, side entry, without adaptor *					CFO 48 L29	29	MFO 48 L32	32
with pegs, side entry, without adaptor *					CFO 48 L	36	MFO 48 L40	40
with pegs, side entry, without adaptor *					CFO 48 L42	42	MFO 48 L50	50
with pegs, top entry					CHV 48 L29	29	MHV 48 L32	32
with pegs, top entry					CHV 48 L	36	MHV 48 L40	40
with pegs, top entry					CHV 48 L42	42	MHV 48 L50	50
with pegs, top entry, without adaptor *					CFV 48 L29	29	MFV 48 L32	32
with pegs, top entry, without adaptor *					CFV 48 L	36	MFV 48 L40	40
with pegs, top entry, without adaptor *					CFV 48 L42	42	MFV 48 L50	50

* enclosure without adaptor, threaded on the body, to be used only with a complete cable gland.

panel cut-out for bulkhead mounting housings in mm

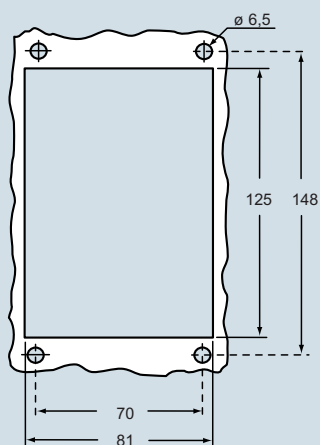

NB: the enclosures ensure IP66 protection (or IP65 for cover versions) rating when mated and locked with the closing levers.

dimensions in mm

CHI L - LS

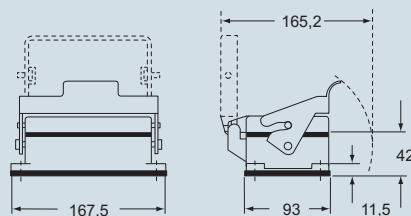

CHP LS and MHP LS

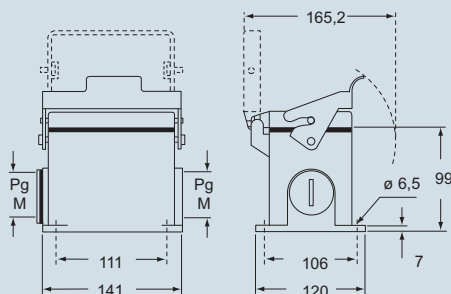

dimensions in mm

CHO/CFO L and MHO/MFO L

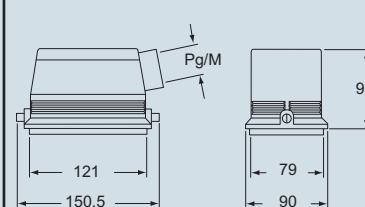

CHV/CFV L and MHV/MFV L

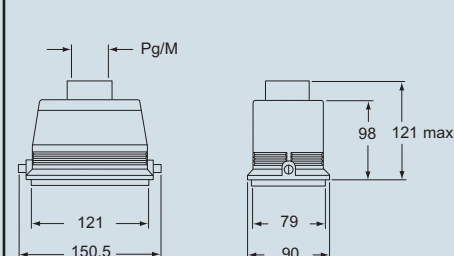

cRU[®] US Type 4/4X/12



dimensions shown are not binding
and may be changed without notice